



## Force, Tension & Torque

Torque Screwdrivers .....	600
Coaxial Torque Wrench .....	604
Torque Wrenches .....	605
Digital Torque Wrenches .....	612
Torque Adapters & Multipliers .....	622
Torque Drivers .....	624
Torque Nutrunners .....	630
Desoutter Tool Management.....	636
Desoutter Torque Controllers .....	637
Torque Testing Solutions .....	638
Tensiometers & Equipment.....	648

# Torque Screwdrivers

## A convincing Concept – The exact Torque!

Made to EN ISO 6798, BS EN 26789, ASME B107.14M standards for repeated fastening of sensitive and expensive components in assembly, or in final inspections and quality assurance applications.

Also available in ESD safe and 1000V insulated versions!



### WIHA TORQUEFIX® FACTORY PRESET

- TorqueFix® Torque Screwdriver with a Fixed Torque Value pre-set by Wiha.
- ±6%, Traceable to national standards
- Special requirement torque settings on request.



Part No.	Nm	⊖	⊕	⊕
28501040	0.4	4	112	23
28501050	0.5	4	112	23
28501060	0.6	4	112	23
28501080	0.8	4	112	23
28501090	0.9	4	112	23
28501110	1.1	4	119	30
28501120	1.2	4	119	30
28501150	1.5	4	119	30
28501200	2.0	4	119	30
28501250	2.5	4	119	30
28501300	3.0	4	126	36
28501380	3.8	4	126	36
28501500	5.0	4	132	41
28501550	5.5	4	132	41
28501600	6.0	4	132	41
28501720	7.2	4	132	41

### WIHA TORQUEVARIO®-S: ADJUSTABLE WITH SCALE

- TorqueVario®-S Torque Screwdriver with Torque Value can be set via Window Scale
- Supplied with torque setter
- ±6%, traceable to national standards (\*Model 0.1-0.6Nm = ±10%)



Part No.	Nm	⊖	⊕	⊕
28521060	0.1-0.6*	4	127	23
28521100	0.4-1.0	4	127	23
28521200	0.8-2.0	4	131	30
28521500	1.0-5.0	4	138	36
28521800	2.0-8.0	4	142	41



Wide range of interchangeable blades available

SoftFinish Ergonomic handles with superior gripping & slip resistance

Clear window scale

### WIHA TORQUEVARIO® SET

Set of 13 pieces:  
Universal bit holder,  
10 bits (PH1, PH2, PZ1,  
PZ2, T10, T15, T20,  
T25, 2.5 flat, 3.0 flat),  
Torque Vario 1.0 - 5.0  
Nm and torque setter



Part No.	Description
268 930	Torque Vario Set 1.0 - 5.0Nm

### WIHA TORQUEVARIO® SET

Set of 13 pieces:  
Universal bit holder,  
10 bits (T7, T8, T9,  
T10, T15, 7IP, 8IP, 9IP,  
10IP, 15IP)  
Torque Vario 1.0 - 5.0  
Nm and torque setter



Part No.	Description
346 140	Torque Vario Set 1.0 - 5.0Nm

### WIHA EASYTORQUE PRESET TORQUE SCREWDRIVER

- Multi-component handle designed for the hand enables optimal power transmission
- Audible and perceptible click when the pre-set torque has been attained
- Rapid identification with imprint on handle end
- Use with a Wiha torque interchangeable blade



Part No.	Nm	⊖	⊕	⊕
36229	0.5	4	130	34
36230	0.6	4	130	34
36240	0.9	4	130	34
36231	1.1	4	130	34
36233	1.2	4	130	34
36234	1.4	4	130	34
36235	1.4	4	130	34
36236	2.5	4	130	34
36237	3.0	4	130	34
36238	3.8	4	130	34
36320	4.0	4	130	34
36321	4.5	4	130	34
36239	5.0	4	130	34

## Digital iTorque Mechatronic Torque Screwdrivers

- Torque value can be set via a digital scale. Automatic release with calibration alert.
- Torque can be conveniently set directly via push button integrated in handle. Ergonomic plastic/metal compound handle of quality, robust materials. Handle sizes proportioned to optimise torque setting. Distinctly audible and perceptible click signal when set torque is reached. [%s]
- According to EN ISO 6798, BS EN 26789, ASME B107.14M standards
- ±6% accuracy, traceable to national standards.
- Torque bit universal holder exchange blade for accommodating (1/4") bits (included in delivery).
- For applications where recommended torque settings are important. Use in combination with a Wiha torque interchangeable blade.
- Click Control – integrated counter records all applications. Calibration alert following 5,000 applications (normative reference value/resettable) Large digital display for simple stepless setting of torque value. Units can be simply switched – Nm > in.lbs / Ncm > in.oz. A high service life: Can be recalibrated by Wiha Services Can be individualised in the order process – information available at mytorque.wiha.com.
- Products can be designed individually using the configurator at mytorque.wiha.com. (Can be chosen freely: two text fields, graphics field, calibration alarm, torque unit)

Many more interchangeable blades available to order!

Ergonomic plastic/metal compound handle of quality, robust materials. Handle sizes proportioned to optimise torque setting.



Distinctly audible and perceptible click signal when set torque is reached.

Torque can be conveniently set directly via push button integrated in handle.

### WIHA iTORQUE DIGITAL TORQUE SCREWDRIVER

- Digital Wiha iTorque variable Torque Screwdriver
- Supplied with universal bit holder (Suits 1/4 insert bits)



Part No.	Nm	lbs	⊖	⊕	⊕
36886	0.4-1.5	60-210 in.oz	4	134	34
36887	0.8-3.0	7-26 in.lbs	4	134	34
36888	1.0-5.0	9-50 in.lbs	4	134	40

### WIHA TORQUE 1/4" UNIVERSAL BIT HOLDER



Part No.	⊖	⊕	⊕
27526	1/4"	4	155

### WIHA 1/4" SQUARE DRIVE ADAPTER BLADE



Part No.	⊖	⊕	⊕
26229	1/4"	4	155

### WIHA SLOTTED INTERCHANGEABLE BLADE



Part No.	⊖	⊕	⊕	max. Nm	
26227	1.5	4	175	42	0.15
26228	2.0	4	175	42	0.4
26151	2.5	4	175	42	0.4
26277	3.0	4	175	42	0.6
26278	3.5	4	175	42	1.1
26279	4.0	4	175	42	2.5

### WIHA PHILLIPS® INTERCHANGEABLE BLADE



Part No.	⊕	⊕	⊕	max. Nm	
26197	PH0	4	175	42	0.4
26058	PH1	4	175	42	3.8
27079	PH2	4	175	42	5.5

### WIHA HEX INTERCHANGEABLE BLADE



Part No.	⊕	⊕	⊕	⊕	max. Nm
26544	1.3	4	175	42	0.4
26200	1.5	4	175	42	0.9
26060	2.0	4	175	42	1.8
26061	2.5	4	175	42	3.8
26062	3.0	4	175	42	5.5
26063	4.0	4	175	42	8.0

### WIHA TORX® INTERCHANGEABLE BLADE



Part No.	⊕	⊕	⊕	⊕	max. Nm
27818	T6	4	175	42	0.6
27812	T7	4	175	42	0.9
27813	T8	4	175	42	1.3
27814	T9	4	175	42	2.5
27816	T10	4	175	42	5.5
27816	T15	4	175	42	5.5
27817	T20	4	175	42	8.0
29467	T25	4	75	42	8.0

- Soft-grip T-handle for extreme comfort and optimal torque transmission. Audible and perceptible click when the pre-set torque has been attained. [%s]
- According to EN ISO 6798, BS EN 26789, ASME B107.14M standards
- ±6%, traceable to national standards.
- For applications where recommended torque settings are important. Use in combination with an interchangeable 6 mm blade for Wiha T-handle torque tools.
- Delivered in plastic case, incl. factory calibration certificate.



#### T-HANDLE TORQUEFIX® FACTORY PRESET



Part No.	Nm	⊙	↑↓	↓
29228	6	6	120	56
29229	8	6	120	56
29230	10	6	120	56
29231	12	6	120	56
29236	12.5	6	120	56
29232	14	6	120	56

#### T-HANDLE TORQUEVARIO® ADJUSTABLE WITH SCALE



Part No.	Nm	⊙	↑↓	↓
2893514	5-14	6	120	56

#### 1/4" UNIVERSAL BIT HOLDER FOR T-HANDLE TORQUE TOOLS



Part No.	⊙	⊕	↑↓
28758	1/4"	6	125

#### TORQUEVARIO® SET

Set of 11 pieces: TorqueVario 5-14Nm, torque setter, 1/4 Adapter and 3/8 Adapter

- 4.0, 5.0, 6.0
- T25, T30, T40



Part No.	Description
292 348	Torque Vario Set 5-14Nm

#### GEDORE TORQUE SCREWDRIVER TYPE FS PRESET

- Adjustable torque screwdriver without scale
- Working Accuracy: +/- 6% tolerance of the set torque
- Acc. to DIN EN ISO 6789, traceable to national standards
- Precision radial ball clutch and cam design for controlled bi-directional tightening
- Precision mechanism slips very noticeably through when the set torque is reached
- Automatic resetting to the starting position
- Anodised aluminium handgrips
- Model 755-05 with additional removable T-bar



Part No.	⊕	⊕	Torque Range		Length
			cN m	N m	
755-01	—	1/4 / 6.3	4.4-22	0.04-0.22	76
755-02	1/4 / 6.3	—	4.4-22	0.04-0.22	104
755-03	1/4 / 6.3	1/4 / 6.3	27-135	0.27-1.35	111
755-04	1/4 / 6.3	1/4 / 6.3	80-400	0.8-4.0	127
755-05	1/4 / 6.3	—	—	2.8-13.6	137

#### GEDORE TORQUE SCREWDRIVER TYPE S VARIABLE

- Adjustable torque screwdriver with scale
- Locking of the value by means of an adjustable knob
- Working Accuracy: +/- 6% tolerance of the set torque
- Acc. to DIN EN ISO 6789, traceable to national standards
- Precision radial ball clutch and cam design for controlled bi-directional tightening
- Precision mechanism slips very noticeably through when the set torque is reached
- Automatic resetting to the starting position
- Anodised aluminium handgrips



Part No.	⊕	⊕	Torque Range		OAL
			cN m	N m	
757-01	1/4 / 6.3	1/4 / 6.3	24-120	0.24-1.2	169mm
757-06	1/4 / 6.3	1/4 / 6.3	120-600	1.2-6	184mm
757-09	1/4 / 6.3	1/4 / 6.3	400-900	4-9	184mm

#### PROTO® TORQUE SCREWDRIVERS – IN-OZ

ASME B107.14M

- Calibrated to ± 4% of torque reading, clockwise at 20% to 100% of full scale.
- 1/4" Square to 1/4" Hex Adapter included for use with insert bits.
- Industrial heavy-duty design.
- Aircraft grade aluminum, aircraft quality spring.
- Positive self locking lock ring.
- Floating three point reaction for repeatability.
- Laser marked easy-to-read scale.
- N.I.S.T. (National Institute of Standards and Technology) traceable certification supplied with J6104ACERT.



Part No.	Drive Size (in)	Torque Range	Increments	Width (in)	Height (in)	OAL (in)	Weight (lbs)
J6104A	1/4	20-100 in oz	2 in oz	1-1/4	1-1/4	6-1/2	1.00
J6104ACERT	1/4	20-100 in oz	2 in oz	1-1/4	1-1/4	6-1/2	1.00
J6106A	1/4	7-36 in lbs	1 in lbs	1-1/4	1-1/4	6-1/2	1.00
J6106ACERT	1/4	7-36 in lbs	1 in lbs	1-1/4	1-1/4	6-1/2	1.00

#### STAHLWILLE TORQUE SCREWDRIVERS TORSIOMETER 760

- Indicating type
- The measuring element is a torsional leaf spring
- Clockwise tightening (with trailing pointer) and anticlockwise tightening
- With 1/4" internal hex drive (F 6.3 DIN 3126)
- Comparative scale in in-lb and cursor
- Inserts and adaptors with external hex E 6.3 (1/4")
- DIN 3126/ISO 1173 are securely held and firmly controlled in the mounting shaft (for bit screwdriver inserts, refer to page 184)
- To attach 1/4" sockets, please order adaptor No 3115 (refer to page 182)
- Certificate in accordance with DIN EN ISO 6789-2:2017
- Display deviation value ± 4%



Part No.	Size	Torque Range (in-lb)	Torque Range (cN m)	Increments (cN m)	Diameter (mm)	OAL (mm)	Weight (g)
51 04 00 07	7.5	1.5-6.5	15-75	2.5	F 6.3	185	225
51 04 00 15	15	3-13	30-150	5	F 6.3	185	225
51 04 00 30	30	6-26	60-300	10	F 6.3	185	230
51 04 00 60	60	15-52	120-600	20	F 6.3	185	230

#### STAHLWILLE TORQUE SCREWDRIVERS TORSIOMAX 775

- Click-type
- For torque-controlled bolt tightening in the cN-m and in-lb ranges
- For one-off or production runs
- Anticlockwise and clockwise tightening
- With 1/4" internal hex drive (F 6.3 DIN 3126/ISO1173)
- Infinitely variable via micrometer scale (twist scale)
- Disengaging clutch coupling prevents the preset value being exceeded
- The shape of the handle and its surface texture ensure safe and accurate transmission of torque
- Insert tools: For all 1/4" hex E 6.3, Phillips-head screws, POZIDRIV/ SUPADRIV®, straight-slot, TORX®, hex bits (see pp. 184)
- Certificate in accordance with DIN EN ISO 6789-2:2017
- Display deviation value ± 6%



Part No.	Size	Fig	Torque Range (cN m)	Increments (cN m)	Torque Range (in lb)	Increments (in lb)	Diameter (mm)	OAL (mm)	Weight (g)
51 06 00 03	3	A	2-30	0.2			F 6.3	105	55
51 06 00 12	12	B	20-120	1			F 6.3	157	180
51 06 00 30	30	B	40-300	1			F 6.3	160	205
51 06 00 50	50		100-500	2.5			F 6.3	205	420
51 06 01 00	100	C	400-1000	5			F 6.3	235	630
51 46 00 03	a/3				0.2-3	0.02	F 6.3	105	55
51 46 00 12	a/12				2-12	0.1	F 6.3	157	200
51 46 00 50	a/50				10-50	0.25	F 6.3	205	440

## STAHLWILLE TORQUE SCREWDRIVERS TORSIOTRONIC® 10



- Indicating and click-type
- Integrated ratcheting bit-holder with 80 teeth that provide a particularly small ratchet angle of only 4.5° and thus enable particularly sensitive working – ideal for hard-to-reach fasteners
- After the tool trips, the slip mechanism prevents the preset tightening torque from being inadvertently exceeded, which protects against overtightening
- Clear display of all the relevant information in a bright, battery-saving colour OLED display – readable at almost any angle
- Visual assessment of the torqueing action by means of the traffic light colours in the display and laterally placed LEDs
- Display in a number of languages
- Long-lasting battery charge with battery-saving stand-by mode. The rechargeable batteries can be quickly and easily changed.
- Stores up to 2500 fasteners and sequences for reading out and documenting on the PC later by means of the integrated micro-USB interface
- The target torque and tolerances can be individually set to evaluate the readings
- Easy learning curve thanks to almost self-explanatory controls and an easily understood menu structure
- Three operating modes (first peak, track, peak hold)
- Tactile, visual and acoustic trigger signals.
- The ergonomically designed convex handle promotes strain-free working and is resistant to oils, grease, fuels, brake fluids and Skydrol
- Clockwise and anticlockwise operation
- With 1/4" male square drive (6.3 DIN 3120/ISO 1174-1) for 1/4" sockets
- With 1/4" female square drive in the handle end (6.3 DIN 3120/ISO 1174-1) for attaching a 1/4" T-bar
- Units of measure: cN·m, N·m, ft·lb, in·lb, in·oz
- Included in the set: SENSOMASTER 4 software, USB cable, bit holder, T-bar handle (size 10)
- Supplied with 3.6 V lithium battery, type 18650, packaged according to UN 3480
- Certificate in accordance with DIN EN ISO 6789-2:2017
- In robust plastic case
- Display deviation value ± 4%



Part No.	Size	Torque Range (cN m)	Torque Range (N m)	Torque Range (ft lb)	Torque Range (in lb)	Torque Range (in oz)	OAL (mm)	Weight (g)
96 51 07 12	1.2	12-120	0.12-1.2	0.08-0.885	1.06-10.7	16.9-169.9	317	569
96 51 07 30	3	30-300	0.3-3	0.2-2.3	2.6-26.6	42-425	317	570
96 51 07 60	6	60-600	0.6-6	0.4-4.45	5.3-53.1	84.5-849.5	317	572
96 51 07 00	10	100-1000	1-10	0.7-7.3	8.8-88.5	141-1417	317	575
96 51 17 12	1.2	12-120	0.12-1.2	0.08-0.885	1.06-10.7	16.9-169.9	317	523
96 51 17 30	3	30-300	0.3-3	0.2-2.3	2.6-26.6	42-425	317	524
96 51 17 60	6	60-600	0.6-6	0.4-4.45	5.3-53.1	84.5-849.5	317	526
96 51 17 00	10	100-1000	1-10	0.7-7.3	8.8-88.5	141-1417	317	529

## Coaxial Torque Wrench

### COAXIAL TORQUE SPANNER

Torque spanner for 8mm AF nuts preset to 1N.m, specifically for use with coaxial connectors.



Part No.	Description	OAL
CHD0801	Coax Torque Spanner	131mm

## Torque Wrenches

### PROTO® RATCHETING HEAD MICROMETER TORQUE WRENCHES – IN-LBS MEETS ASME STANDARD

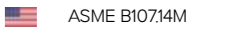

- Calibrated to +/- 3% clockwise direction (for J6060A, calibrated to +/- 4% clockwise direction) and +/- 6% counter clockwise direction at 20% to 100% of full scale.
- Calibration is accomplished by manually loading the torque wrench.
- Manufactured to meet standard industrial torque applications such as general industry, heavy equipment and maintenance.



Part No.	Drive Size (in)	Torque Range (in-lbs)	Increments (in-lbs)	Head Width (in)	Head Depth (in)	OAL (in)	Weight (lbs)	Storage Case	Repair Kit
J6060A	1/4	10-50	1	1-1/16	7/8	9-1/2	1.20	J6006PBF	J6062RK
J6062C	1/4	40-200	1	1-1/32	3/4	11-7/8	2.60	J6006PBF	J6062RK
J6064C	3/8	40-200	1	1-1/32	7/8	11-7/8	2.60	J6006PBF	J6064RK
J6066C	3/8	200-1000	5	1-7/16	1-1/64	15-1/2	3.00	J6006PBF	J6006RK
J6068C	1/2	360-1800	10	1-7/8	1-13/32	21-1/2	5.00	J6014PBF	J6014RK
J6072C	1/2	600-3000	10	1-7/8	1-13/32	27-1/8	5.90	J6014PBF	J6014RK

### PROTO® RATCHETING HEAD MICROMETER TORQUE WRENCHES – FT-LBS MEETS ASME STANDARD



- Calibrated to +/- 3% clockwise direction and +/- 6% counter clockwise at 20% to 100% of full scale.
- Calibration is accomplished by manual loading the torque wrenches.
- Manufactured to meet standard industrial torque applications, general industry, heavy equipment, and maintenance.

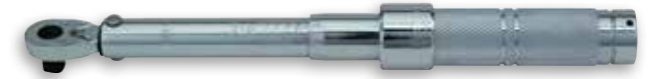

Part No.	Drive Size (in)	Torque Range (ft-lbs)	Increments (ft-lbs)	Head Width (in)	Head Depth (in)	OAL (in)	Weight (lbs)	Storage Case	Repair Kit
J6006C	3/8	16-80	0.5	1-7/16	1-1/64	15-1/2	3.00	J6006PBF	J6006RK
J6012C	3/8	20-100	0.5	1-7/16	1-1/64	17	3.30	J6006PBF	J6006RK
J6008C	1/2	16-80	0.5	1-7/16	1-7/32	15-1/2	3.00	J6006PBF	J6008RK
J6016C	1/2	30-150	1	1-7/8	1-13/32	21-1/2	5.00	J6014PBF	J6014RK
J6014C	1/2	50-250	1	1-7/8	1-13/32	27-1/8	5.90	J6014PBF	J6014RK
J6018AB	3/4	60-300	2	2-5/8	2-1/16	32-23/32	14.00	J6007PB	J6018RK
J6020AB	3/4	120-600	2	2-5/8	2-1/16	41-9/16	15.50	J6007PB	J6018RK
J6022B	1	140-700	2	2-5/8	2-5/16	46-27/32	20.50	J6007PB	J6022RK

### PROTO® RATCHETING HEAD MICROMETER TORQUE WRENCHES – NM MEETS ASME STANDARD



- Calibrated to +/- 3% clockwise direction and +/- 6% counter clockwise direction at 20% to 100% of full scale.
- Calibration is accomplished by manual loading the torque wrenches.
- Manufactured to meet standard industrial torque applications, general industry, heavy equipment, and maintenance.



Part No.	Drive Size (in)	Torque Range (Nm)	Increments (Nm)	Head Width (in)	Head Depth (in)	OAL (in)	Weight (lbs)	Storage Case	Repair Kit
J6006MC	3/8	16-80	0.5	1-7/16	1-1/64	15-1/2	3.00	J6006PBF	J6006RK
J6006NMC	3/8	16-80	0.5	1-7/16	1-1/64	15-1/2	3.00	J6006PBF	J6006RK
J6016MC	1/2	40-200	1	1-7/8	1-13/32	21-1/2	5.00	J6014PBF	J6014RK
J6016NMC	1/2	40-200	1	1-7/8	1-13/32	21-1/2	5.00	J6014PBF	J6014RK
J6014MC	1/2	70-350	1	1-7/8	1-13/32	27-1/8	5.90	J6014PBF	J6014RK
J6014NMC	1/2	70-350	1	1-7/8	1-13/32	27-1/8	5.90	J6014PBF	J6014RK
J6020NM	3/4	160-800	4	2-5/8	2-1/16	41-9/16	15.50	J6007PB	J6018RK

**PROTO® FIXED HEAD MICROMETER TORQUE WRENCHES – IN-LBS  
MEETS ASME STANDARD**

ASME B10714M

- Calibrated to +/- 3% clockwise direction and +/- 6% and counter clockwise direction at 20% to 100% of full scale.
- Calibration is accomplished by manual loading the torque wrenches.
- Manufactured to meet standard industrial torque applications, general industry, heavy equipment, and maintenance.



Part No.	Drive Size (in)	Torque Range (in-lbs)	Increments (in-lbs)	Head Width (in)	Head Depth (in)	OAL (in)	Weight (lbs)	Storage Case
J6061C	1/4	40-200	1	25/32	3/4	11-45/64	2.60	J6006PBF
J6063C	3/8	40-200	1	25/32	7/8	11-45/64	2.60	J6006PBF
J6065C	3/8	200-1000	5	55/64	7/8	15-13/64	3.00	J6006PBF

**PROTO® FIXED HEAD MICROMETER TORQUE WRENCHES – FT-LBS  
MEETS ASME STANDARD**

ASME B10714M

- Calibrated to +/- 3% clockwise direction and +/- 6% counter clockwise at 20% to 100% of full scale.
- Calibration is accomplished by manual loading the torque wrenches.
- Manufactured to meet standard industrial torque applications, general industry, heavy equipment, and maintenance.



Part No.	Drive Size (in)	Torque Range (ft-lbs)	Increments (ft-lbs)	Head Width (in)	Head Depth (in)	OAL (in)	Weight (lbs)	Storage Case
J6005C	3/8	16-80	0.5	55/64	7/8	15-13/64	3.00	J6006PBF
J6013C	1/2	50-250	1	1-1/8	1-7/32	26-23/32	5.90	J6014PBF
J6015C	1/2	30-150	1	1-1/8	1-7/32	21-1/8	5.00	J6014PBF
J6017B	3/4	120-600	2	1-7/8	1-7/8	41-11/64	15.50	J6007PB

**PROTO® FIXED HEAD MICROMETER TORQUE WRENCH 200-1000 FT-LBS**

ASME B10714M  
AS28431  
TO33K6-4-2193-1  
ISO 6789  
JIS B4650

- Includes an extension handle.
- Torque wrench is 40" long. Weight and over all length are for torque wrench with the extension handle.
- Packaged in a metal box for easy storage.
- Calibrated ± 4% of torque reading clockwise and ±6% counter clockwise at 20% to 100% of full scale.
- Certified wrenches to ±2% one direction are available upon request.



Part No.	Drive Size (in)	Torque Range (ft-lbs)	Increments (ft-lbs)	Head Width (in)	Head Depth (in)	OAL (in)	Weight (lbs)
J6023	1	200-1000	5	1-7/8	2-1/4	69	24.50

**PROTO® FIXED HEAD MICROMETER TORQUE WRENCH 400-2000 FT-LBS**

ASME B10714M  
AS28431  
TO33K6-4-2193-1  
ISO 6789  
JIS B4650

- Includes two extension handles, each 43" long.
- Torque wrench is 34-1/4" long. Weight and overall length are for torque wrench assembled with both extension handles.
- Calibrated ±4% of torque reading clockwise and ±6% counter clockwise at 20% to 100% of full scale.



Part No.	Drive Size (in)	Torque Range (ft-lbs)	Increments (ft-lbs)	Head Width (in)	Head Depth (in)	OAL (in)	Weight (lbs)
J6025	1	400-2000	10	3-1/16	4-1/8	107-1/2	53.1

**PROTO® DIAL TORQUE WRENCHES – FT-LBS/MKG**

ASME B10714M  
ISO 6789  
JIS B4650

- Accurate to ± 4% of torque reading in both directions at 20% to 100% of full scale.
- Industrial all steel or aluminum torque transfer components.
- High alloy torsion drive design — accuracy not effected by hand position.
- Dual scale (English/Metric) with clockwise and counterclockwise operation — fewer wrenches needed to complete job.
- Memory needles are standard on all wrenches except electric light models.
- Easy-to-read, high contrast scale.
- Laser marked serial number for traceability.
- N.I.S.T. (National Institute of Standards and Technology) traceable CW certification supplied with each wrench.
- J6133F and J6141F include one removeable extension handle for easy force application.
- J6149F includes five removeable extensions (requires two operators) and electric LED and buzzer.



J6113F



J6121F



J6149F



J6133F

Part No.	Drive Size (in)	Torque Range (ft-lbs)	Torque Range (metric)	Increments (in-lbs)	OAL (in)	Weight (lbs)
J6113F	3/8	10-50	1.4-7 mkg	1	10-1/4	2.20
J6121F	1/2	35-175	5-24 mkg	5	21-1/2	4.00
J6125F	1/2	50-250	7-35 mkg	5	21-1/2	3.80
J6134F	3/4	70-350	—	10	27-7/8	7.10
J6133F	3/4	120-600	16-80 mkg	10	46-1/2	9.90
J6141F	1	200-1000	28-140 mkg	20	74-1/4	27.00
J6149F	1	400-2000	56-280 mkg	40	110-3/4	48.00

**PROTO® DIAL TORQUE WRENCHES – NM/IN-LBS, FT-LBS**

ASME B10714M

- 2-10 Nm thru 50-250 Nm / 18-90 in-lbs. thru 35-175 ft-lbs
- Accurate to ± 4% of torque reading in both directions at 20% to 100% of full scale.
- Industrial all steel or aluminum torque transfer components.
- High alloy torsion drive design — accuracy not effected by hand position.
- Dual scale (Metric/English) with clockwise and counterclockwise operation — fewer wrenches needed to complete job.
- Memory needles are standard on all wrenches except electric light models.
- Easy-to-read, high contrast scale.
- Laser marked serial number for traceability.
- N.I.S.T. (National Institute of Standards and Technology) traceable CW certification supplied with each wrench.



Part No.	Drive Size (in)	Torque Range (ft-lbs)	Increments (ft-lbs)	Head Width (in)	Head Depth (in)	OAL (in)	Weight (lbs)
J6169NMF	1/4	—	18-90	2-10	0.2	10	1.30
J6177NMF	3/8	—	50-250	6-30	0.5	10	1.50
J6113NMF	3/8	10-50	—	14-70	2	14-7/8	2.10
J6121NMF	1/2	35-175	—	50-250	5	21-1/2	4.00

PROTO® DIAL TORQUE WRENCHES – IN-LBS/CM-KG

ASME B107.14M  
ISO 6789  
JIS B4650

- 6-30 in-lbs. thru 120-600 in-lbs. / 7-35 cm-kg thru 140-700 cm-kg.
- Accurate to ± 4% of torque reading in both directions at 20% to 100% of full scale.
- Industrial all steel or aluminum torque transfer components.
- High alloy torsion drive design — accuracy not effected by hand position.
- Dual scale (English/Metric) with clockwise and counterclockwise operation — fewer wrenches needed to complete job.
- Memory needles are standard on all wrenches except electric light models.
- Easy-to-read, high contrast scale.
- Laser marked serial number for traceability.
- N.I.S.T. (National Institute of Standards and Technology) traceable CW certification supplied with each wrench.



Part No.	Drive Size (in)	Torque Range (metric)	Torque Range (in-lbs)	Increments (in-lbs)	OAL (in)	Weight (lbs)
J6168F	1/4	7-35 cm-kg	6-30	0.5	10	1.00
J6169F	1/4	18-90 cm-kg	15-75	1	10	1.40
J6177F	3/8	56-280 cm-kg	50-250	5	10	1.30
J6181F	3/8	140-700 cm-kg	120-600	10	10	2.20

PROTO® DIAL ELECTRONIC TORQUE WRENCHES – IN-LBS, FT-LBS

ASME B107.300

- Extended operation range in ft-lbs., in-lbs. and Nm units.
- Precision Accuracy: + / - 1% in BOTH directions.
- Accuracy valid from 10% to 100% of full scale.
- Large easy to read digits.
- Patented rotary bezel. LCD and key pad rotate both ways, up to 359 degrees for easy viewing.
- Torque target zone adjustable 1% to 10% indicates when the desired torque limit is approaching.
  - Yellow light indicates the low end of the zone
  - Green light and buzzer sounds when the target is reached
  - Red Light with intermittent buzzer indicates over-torqued
- One button target torque setting.
- Ergonomically designed for user comfort.
- Operates on standard 9 volt battery.
- Torsion drive strain gauge technology improves accuracy.
- Users can pull on the handle anywhere and still maintain accuracy.
- Built on durable chrome body (not painted) with nylon-6 rotary bezel.
- Rotary dial is shrouded with metal walls to protect display.
- Peak, hold and track modes standard.
- Fast sampling rate helps maintain high accuracy during torque applications.
- Easy to use by production line or quality control inspector.



J6345



J6345B



J6351

Part No.	Drive Size (in)	Torque Range (ft-lbs)	Torque Range (in-lbs)	Torque Range (Nm)	Increments (ft-lbs)	Increments (in-lbs)	Increments (Nm)	Width (in)	Height (in)	OAL (in)	Weight (lbs)
J6339	1/4	0.63-6.25	7.5-75	0.84-8.47	0.01	0.01	0.01	3	2-1/2	11	1.40
J6342	1/4	0.83-8.33	10-100	1.11-11.3	0.01	0.1	0.01	3	2-1/2	11	1.40
J6345	3/8	2.1-21	25-250	2.8-28.2	0.01	0.1	0.01	3	2-1/2	11	1.40
J6345A	3/8	5-50	60-600	6.78-67.8	0.01	0.1	0.1	3	2-1/2	11	1.40
J6345B	1/2	10-100	120-1200	13.3-133.5	0.01	1	1	3	4	22	2.80
J6346	1/2	25-250	300-3000	33.8-338	0.1	1	0.1	3	4	22	2.80
J6347	3/4	60-600	720-7200	81-813	0.1	1	0.1	3	4	22	2.80
J6349	1	100-1000	-	140-1400	-	-	-	4	5	77	20.00
J6351	1	200-2000	-	271-2700	-	-	-	4	5	125	46.00

STAHLWILLE TORQUE WRENCH INDUSTRIAL MANOSKOP® 755



- For work on production lines or series production. No setting scale; have to be set with testers
- Click-type
- Any force applied to the tool after the 'click' or applied in the opposite direction to the current function (up to the maximum of the wrench's range) does not act on the trigger mechanism and cannot cause damage to it
- Mount for interchangeable insert tools (755/4-30)
- Dual stop signal
- Particularly light and easy to handle
- Handle and shank are made of square tubular steel
- Anticlockwise torquing thanks to swap-over insert tools
- On request with preset cut-out value (surcharge 10%)
- Display deviation value ± 4%



Part No.	Size	Torque Range (ft lb)	Torque Range (N m)	Mount Size (mm)	OAL (mm)	Weight (g)
50 01 00 04	4	4-30	4-40	9 x 12	201	500
50 01 00 10	10	15-74	20-100	9 x 12	318	635
50 01 00 20	20	30-147	40-200	14 x 18	457	1045
50 01 00 30	30	40-220	60-300	14 x 18	609	1210

755R/1 WITH PERMANENTLY INSTALLED RATCHET



Part No.	Size	Torque Range (ft lb)	Torque Range (N m)	OAL (mm)	Weight (g)
50 10 00 01	1/4 in	1.0-9.0	1.5-12.5	173.5	335

STAHLWILLE TORQUE WRENCH SERVICE MANOSKOP® 730 QUICK WITH MOUNT



- Click-type
- The measuring element is only under load while force is being applied, no need for manual reset to zero
- Mount for interchangeable insert/shell tools
- QuickRelease safety lock (sizes 5–65)
- Rapid setting thanks to easy-action locking lever in the handle (sizes 5–65)
- Ergonomically designed, non-slip adjuster with a thumb recess
- Magnifying glass integrated in the display window
- Optimised convex handle for strain-free working
- Dual stop signal
- Twin scales N-m/ft-lb and N-m/in-lb (sizes 5–80)
- On request also available as an N-m-only version without twin scale (sizes 5-65)
- Can be applied for either clockwise or anticlockwise tightening by turning the inserts over
- Any force applied to the tool after the 'click' or applied in the opposite direction to the current function – e.g. forcible loosening of a jammed screw - does not act on the trigger mechanism and cannot cause damage to it
- Calibration using perfectControl® calibrating unit No 7794 or calibration system No 7706. Readjustment does not require disassembly.
- Certificate in accordance with DIN EN ISO 6789-2:2017
- Display deviation value ± 4%



Part No.	Size	Torque Range (ft lb)	Increments (ft lb)	Torque Range (N m)	Increments (N m)	Mount Size (mm)	OAL (mm)	Weight (g)
50 18 40 05	5	5-36	1	6-50	2	9 x 12	315	780
50 18 40 10	10	15-72.5	2.5	20-100	2.5	9 x 12	370	936
50 18 40 12	12	20-95	2.5	25-130	2.5	14 x 18	410	1074
50 18 40 20	20	30-145	5	40-200	5	14 x 18	455	1310
50 18 40 40	40	60-300	10	80-400	10	14 x 18	590	1540
50 18 40 65	65	100-480	20	130-650	20	14 x 18	875	3192
50 18 45 65	11/65	100-480	20	130-650	20	22 x 28	897	4104
50 58 40 05	a/5	50-440 in lb	10 in lb	6-50	2	9 x 12	315	780
50 58 40 10	a/10	180-880 in lb	20 in lb	20-100	2.5	9 x 12	370	934
50 58 40 12	a/12	225-1150 in lb	25 in lb	25-130	2.5	14 x 18	410	1076
50 58 40 20	a/20	350-1750 in lb	50 in lb	40-200	5	14 x 18	455	1216

WITH TOOL CARRIER



Part No.	Size	Torque Range (in lb)	Increments (in lb)	Torque Range (N m)	Increments (N m)	Mount Size (mm)	OAL (mm)	Weight (g)
50 18 40 02	2			4-20	0.5	9 x 12	179	315
50 18 40 04	4			8-40	1	9 x 12	223	395
50 58 40 01	a/2-1	175-875	2.5			9 x 12	179	315
50 58 40 02	a/2	30-175	5			9 x 12	179	315
50 58 40 04	a/4	70-350	10			9 x 12	223	395

### STAHLWILLE TORQUE WRENCH STANDARD MANOSKOP® 721 QUICK WITH PERMANENTLY INSTALLED RATCHET

- Click-type
- The measuring element is only under load while force is being applied, no need for manual reset to zero
- Rapid setting thanks to easy-action locking lever in the handle
- Ergonomically designed, non-slip adjuster with a thumb recess
- Magnifying glass integrated in the display window
- Dual stop signal
- Twin scales N·m/ft·lb
- Optimised convex handle for strain-free working
- Any force applied to the tool after the 'click' or applied in the opposite direction to the current function – e.g. forcible loosening of a jammed screw - does not act on the trigger mechanism and cannot cause damage to it
- All the sensitive components are protected by the sturdy tubular steel housing
- Calibration using perfectControl® calibrating unit No 7794 or calibration system No 7706. Readjustment does not require disassembly.
- Certificate in accordance with DIN EN ISO 6789-2:2017
- Display deviation value ± 4%



Part No.	Size	Torque Range (ft lb)	Increments (ft lb)	Torque Range (N m)	Increments (N m)	Drive Size (in)	OAL (mm)	Weight (g)
50 20 40 05	5	5-36	1	6-50	2	3/8	352	880
50 20 40 15	15	25-110	5	30-150	5	1/2	452	1282
50 20 40 20	20	30-145	5	40-200	5	1/2	483	1349
50 20 40 30	30	50-220	10	60-300	10	1/2	553	1646

### 721QR QUICK WITH PERMANENTLY INSTALLED QUICKRELEASE RATCHET



Part No.	Size	Torque Range (ft lb)	Increments (ft lb)	Torque Range (N m)	Increments (N m)	Drive Size (in)	OAL (mm)	Weight (g)
50 20 41 15	15	25-110	5	30-150	5	1/2	452.5	1268
50 20 41 20	20	30-145	5	40-200	5	1/2	482	1338

### STAHLWILLE TORQUE WRENCH SERVICE MANOSKOP® 730NR WITH PERMANENTLY INSTALLED FINE-TOOTH RATCHET

- In sturdy plastic box (size 65 in steel box)
- Deviation of indication ± 4%



Part No.	Size	Torque Range (ft lb)	Increments (ft lb)	Torque Range (N m)	Increments (N m)	Drive Size (in)	OAL (mm)	Weight (g)
96 50 31 05	5 FK	7-37	1	10-50	5	3/8	364	973
96 50 31 10	10 FK	15-75	2.5	20-100	10	1/2	420	1146
96 50 31 20	20 FK	30-150	5	40-200	10	1/2	513.5	1583
96 50 21 40	40 FK	60-300	10	80-400	20	3/4	657	2122
96 50 22 65	65 FK-HD	100-480	20	130-650	50	3/4	944	3698

### STAHLWILLE TORQUE WRENCH SERVICE MANOSKOP® 730NR WITH PERMANENTLY INSTALLED FINE-TOOTH RATCHET QUICKRELEASE

- In sturdy plastic box
- With QuickRelease safety lock
- Deviation of indication ± 4%



Part No.	Size	Torque Range (ft lb)	Increments (ft lb)	Torque Range (N m)	Increments (N m)	Drive Size (in)	OAL (mm)	Weight (g)
96 50 21 05	5QR FK	7-37	1	10-50	5 / 0.25	3/8	372.5	961
96 50 21 10	10QR FK	15-75	2.5	20-100	10 / 0.5	1/2	428.5	1129
96 50 21 20	20QR FK	30-150	5	40-200	10 / 1	1/2	526	1589

### STAHLWILLE TORQUE WRENCH SERVICE MANOSKOP® 730N WITH MOUNT

- Click-type
- The measuring element is only under load while force is being applied, no need for manual reset to zero
- Fast, accurate setting thanks to QuickSelect quick-action adjuster
- Dual stop signal
- Easy-to-read double scale with colour coding to differentiate between N·m/ft·lb and ft·lb/in·lb scales
- Any force applied to the tool after the 'click' or applied in the opposite direction to the current function – e.g. forcible loosening of a jammed screw -does not act on the trigger mechanism and cannot cause damage to it
- Two-component handle with ergonomically designed green softer layers (resistant to oils, grease, fuels, brake fluids and skydrol)
- Calibration using perfectControl® calibrating unit No 7794 or calibration system No 7706. Readjustment does not require disassembly.
- Certificate in accordance with DIN EN ISO 6789-2:2017
- Supplied in textile bag (from size 65)



Part No.	Size	Torque Range (ft lb)	Increments (ft lb)	Torque Range (in lb)	Increments (in lb)	Torque Range (N m)	Increments (N m)	Mount Size (mm)	OAL (mm)	Weight (g)
50 18 11 02	2			40-180	10	4-20	1 / 0.2	9 x 12	275	737
50 18 10 05	5	7-37	1			10-50	5 / 0.25	9 x 12	330	831
50 18 10 10	10	15-75	2.5			20-100	10 / 0.5	9 x 12	386	988
50 18 10 12	12	20-95	2.5			25-130	10 / 0.5	14 x 18	421	1128
50 18 10 20	20	30-150	5			40-200	10 / 1	14 x 18	467	1264
50 18 10 40	40	60-300	10			80-400	20 / 2	14 x 18	607	1655
50 18 10 65	65	100-480	20			130-650	50 / 2.5	14 x 18	890	3231
50 18 13 65	11/65	100-480	20			130-650	50 / 2.5	22 x 28	911	3504
50 18 10 80	80	120-600	25			160-800	100 / 5	22 x 28	1178	4825
50 18 11 00	100	150-750	25			200-1000	100 / 5	22 x 28	1363	5000
50 58 11 02	a/2	3-15	0.5	40-180	10 / 2			9 x 12	275	737
50 58 10 05	a/5	7-37	1	90-450	50 / 2.5			9 x 12	330	831
50 58 10 10	a/10	15-75	2.5	180-900	100 / 5			9 x 12	386	988
50 58 10 20	a/20	30-150	5	350-3800	100 / 10			14 x 18	467	1264
50 58 10 40	a/40	60-300	20 / 2	800-3600	100			14 x 18	607	1655

# Digital Torque Wrenches

## PROTO® 1/2" DRIVE ELECTRONIC TORQUE WRENCH

ASME B107.28

- Full interface with Proto® Interchangeable Head Attachments.
- Accuracy of +/- 2% of indicated value in both clockwise and counter clockwise directions.
- Broad accuracy range extends from 10% to 100% of Full Scale to help reduce the number of torque wrenches required.
- Ninety-nine "on-board" memory storage locations help improve efficiency when taking multiple torque readings.
- Three units of measure are available (Ft-lb, In-lb, and Nm).
- Three operating modes: Track Mode, Peak Hold and Auto Clear.
- Fast sampling rate helps maintain high accuracy during torque applications.
- Torque wrench head rotates to allow for easy viewing of LCD display.
- Easy to read LCD Display with large digits.
- 3-way Red/Green/Yellow lights.
- Yellow light appears at the low end of the zone.
- Green light appears and buzzer sounds when the target is reached.
- Red light appears with intermittent buzzer when it is over torqued.
- Audible buzzer helps identify when desired torque target zones are approaching and met.
- Target torque zone is adjustable from 1% to 10% of targeted torque value.

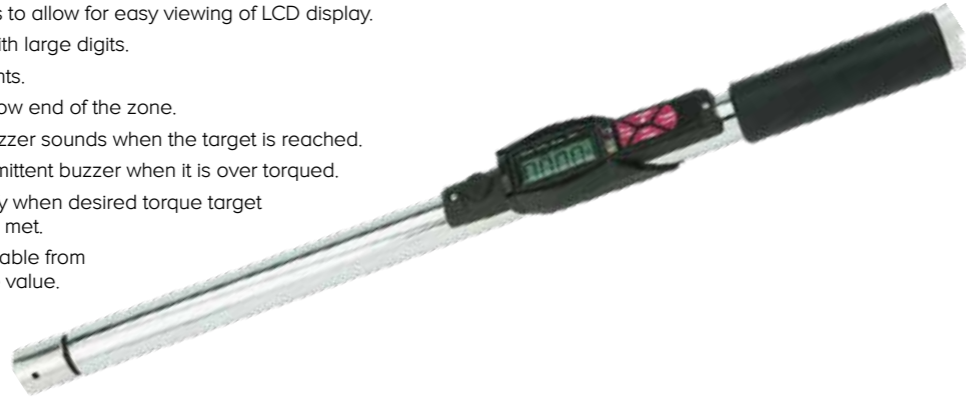

Part No.	Drive Size (in)	Torque Range (ft-lbs)	Increments (ft-lbs)	Torque Range (in-lbs)	Increments (in-lbs)	OAL (in)	Weight (lbs)
JH7-250F	1/2	25-250	0.1	300-3000	1	23	3.00

## PROTO® 1/4" DRIVE ELECTRONIC TORQUE WRENCH

ASME B107.28

- Full interface with Proto® Interchangeable Head Attachments.
- Accuracy of +/- 2% of indicated value in both clockwise and counter clockwise directions.
- Broad accuracy range extends from 10% to 100% of Full Scale to help reduce the number of torque wrenches required.
- Ninety-nine "on-board" memory storage locations help improve efficiency when taking multiple torque readings.
- Three units of measure are available (Ft-lb, In-lb, and Nm).
- Three operating modes: Track Mode, Peak Hold and Auto Clear.
- Fast sampling rate helps maintain high accuracy during torque applications.
- Torque wrench head rotates to allow for easy viewing of LCD display.
- Easy to read LCD Display with large digits.
- 3-way Red/Green/Yellow lights.
- Yellow light appears at the low end of the zone.
- Green light appears and buzzer sounds when the target is reached.
- Red light appears with intermittent buzzer when it is over torqued.
- Audible buzzer helps identify when desired torque target zones are approaching and met.
- Target torque zone is adjustable from 1% to 10% of targeted torque value.

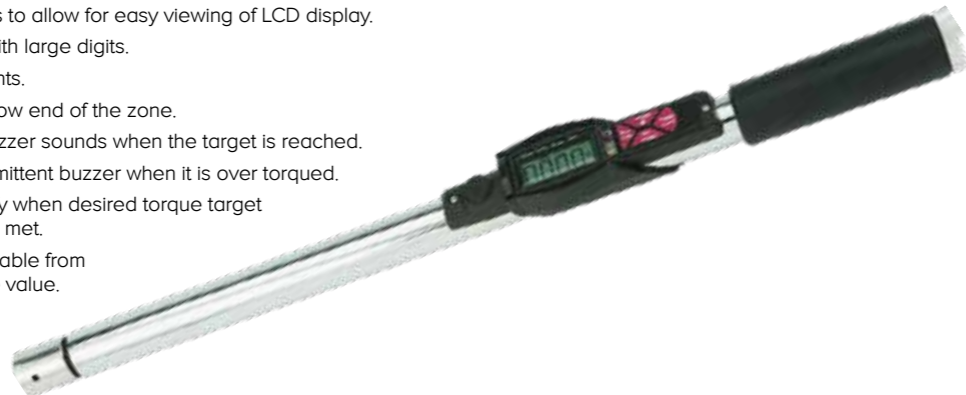

Part No.	Drive Size (in)	Torque Range (ft-lbs)	Increments (ft-lbs)	Torque Range (in-lbs)	Increments (in-lbs)	OAL (in)	Weight (lbs)
JH4-250	1/4	2.1-20.8	0.01	25-250	0.1	17-1/4	2.2

## STAHLWILLE ELECTRONIC TORQUE WRENCH SENSOTORK® 701/2 WITH PERMANENTLY INSTALLED FINE-TOOTH RATCHET QUICKRELEASE

- Indicating
- Slim, compact shape for smaller torques from 1 N-m upwards
- Measuring units: N-m, cN-m, ft-lb, in-lb
- Measurements independent of the point of application of force
- Additional functions using SENSOMASTER 4 software (not included, free download):
  - Adjustable joints
  - Evaluation of tightening operation by means of coloured LEDs, buzzer and vibration
  - Calibrating interval adjustable
  - Logging function
- Supplied with 3.6 V lithium battery, type 14500, packed in accordance with UN3091, Class 9
- Calibration in conjunction with perfectControl® calibrating unit No 7794 or complete calibration system No 7706. Re-adjustment does not require disassembly
- Certificate in accordance with DIN EN ISO 6789-2:2017
- In sturdy plastic box
- Display deviation value ± 4%
- \* without battery / not hazardous



Part No.	Torque Range (cN m)	Increments (in lb)	Torque Range (N m)	Increments (ft lb)	Drive Size (in)	OAL (mm)	Weight (g)
96 50 45 02	100-2000	9-180	1-20	0.7-15	1/4	210	145
96 50 46 02 *	100-2000	9-180	1-20	0.7-15	1/4	210	132

## STAHLWILLE ELECTRONIC TORQUE WRENCH SERVICE MANOSKOP® 730D WITH MOUNT

- Tactile and acoustic trigger signal
- Mount for interchangeable insert tools
- QuickRelease safety lock
- Fast setting using convenient keypad
- Automatic compensation to achieve correct tightening torque even if a changed extension is entered
- Overload protection by means of acoustic and visual signals
- Automatic keypad lock prevents inadvertent changes
- Display also works for anticlockwise torque
- Units of measurement: N-m, ft-lb, in-lb
- Different tolerance limits can be set for each joint
- Visual red and green signals in the display confirm the status of the joint
- Additional security for presets (function mode, trigger or preset value, unit of measurement, tolerance, save, deviating extension) using PIN code
- Up to 7,500 measurements can be stored
- USB interface
- Automatic notification of the next calibration date
- Calibration using perfectControl® calibrating unit No 7794 or calibration system No 7791
- Two-component handle with ergonomically designed green softer layers (resistant to oils, grease, fuels, brake fluids and skydrol)
- Certificate in accordance with DIN EN ISO 6789-2:2017
- In sturdy plastic box (sizes 40-100 in steel box)
- Patent
- Supplied with two 1.5 V AA batteries. AA/LR6, 1.2 V rechargeable cells may also be used
- Display deviation value ± 2%, ± 1 digit

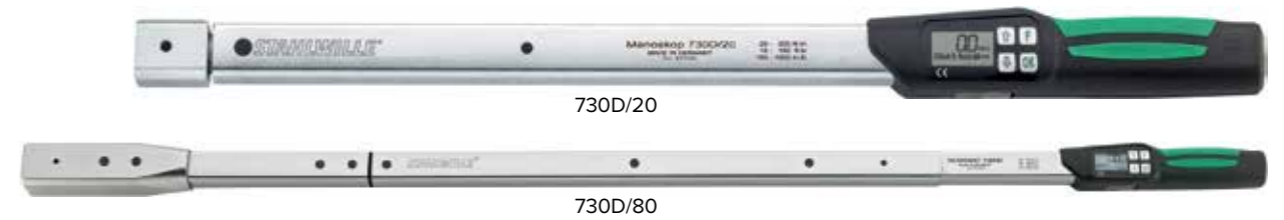

Part No.	Size	Torque Range (ft lb)	Torque Range (in lb)	Torque Range (N m)	Setting/Display Resolution ft lb	Setting/Display Resolution in lb	Setting/Display Resolution N m	Mount Size (mm)	OAL (mm)	Weight (g)
96 50 17 10	10	7.4-75	90-900	10-100	0.2/0.1	2/1.0	0.2/0.1	9 x 12	467	1085
96 50 17 20	20	15-150	180-1800	20-200	0.5/0.1	5/1.0	0.5/0.1	14 x 18	548	1361
96 50 17 40	40	30-300	360-3600	40-400	1.0/0.1	10/1.0	1.0/0.1	14 x 18	688	3300
96 50 17 65	65	48-480	580-5800	65-650	1.0/0.1	10/1.0	1.0/0.1	14 x 18	870	3300
96 50 19 65	11/65	48-480	580-5800	65-650	1.0/0.1	10/1.0	1.0/0.1	22 x 28	892	3224
96 50 20 80	80	60-600	720-7200	80-800	1.0/1.0	10/1.0	1.0/1.0	22 x 28	1160	4577
96 50 21 00	100	74-750	900-9000	100-1000	1.0/1.0	10/1.0	1.0/1.0	22 x 28	1344	4995

## STAHLWILLE JACK CABLE 7751

with Jacks at both ends, 90° angled



Part No.	Description
52 11 00 51	Jack Cable for Manoskop

## STAHLWILLE USB ADAPTOR 7757-1



Part No.	Description
52 11 10 57	USB Adaptor for Manoskop



STAHLWILLE ELECTRONIC TORQUE WRENCH SERVICE MANOSKOP® 730DR WITH REVERSIBLE RATCHET INSERT TOOL



Part No.	Size	Torque Range (ft lb)	Torque Range (in lb)	Torque Range (N m)	Setting/Display Resolution	Mount Size (mm)	Drive Size (in)	OAL (mm)	Weight (g)
96 50 18 10	10	7.4-75	90-900	10-100	0.2/0.1 2/1.0 0.2/0.1	9 x 12	1/2	501	1232
96 50 18 20	20	15-150	180-1800	20-200	0.5/0.1 5/1.0 0.5/0.1	14 x 18	1/2	595	1663
96 50 18 40	40	30-300	360-3600	40-400	1.0/0.1 10/1.0 1.0/0.1	14 x 18	3/4	738	2232
96 50 18 65	65	48-480	580-5800	65-650	1.0/0.1 10/1.0 1.0/0.1	14 x 18	3/4	975	3767
96 50 20 65	11/65	48-480	580-5800	65-650	1.0/0.1 10/1.0 1.0/0.1	22 x 28	3/4	977	3994
96 50 18 80	80	60-600	720-7200	80-800	1.0/1.0 10/1.0 1.0/1.0	22 x 28	3/4	1255	6492
96 50 18 00	100	74-750	900-9000	100-1000	1.0/1.0 10/1.0 1.0/1.0	22 x 28	3/4	1439	6910

STAHLWILLE ELECTROMACHANICAL TORQUE WRENCH ANGLE-CONTROLLED MANOSKOP® 714 WITH MOUNT



- 4 measuring modes (torque, angle, torque backed up by angle, angle backed up by torque)
- high-definition colour display with additional side-mounted indicator lamps
- freely configurable menu structure
- optionally: Li-ion battery No 7195-2 and charger No 7160
- 3 function modes: cut-out, peak hold (indicating mode with peak value) and track (indicating mode with current value)
- micro USB interface
- bayonet connection for battery compartment
- QuickRelease safety lock change system for insert tools
- data storage (≤ 2500 tightening jobs)
- as many as 200 joints can be programmed in up to 25 preset sequences
- different tolerance limits can be set for each joint
- acoustic and visual assessment of the joint
- rapid, accurate setting via keypad
- the automatic keypad lock prevents inadvertent changes
- overload protection by means of acoustic and visual signals and a fail-safe system (clockwise)
- automatic notification of the next calibration date, either by the number of joints or the time interval
- fully automated calibrating and adjusting using the perfectControl® calibrating and adjusting unit No 7794-2 (torque) or 7794-3 (torque and angle)
- units of measure: N-m, ft-lb, in-lb
- tightening torque is automatically corrected if a deviating extension is entered

- immediately reusable after release
- clockwise and anticlockwise tightening – it may be necessary to refit the insert tool rotated through 180° for anticlockwise tightening in the cut-out mode
- tactile and acoustic trigger signal
- torque and angle are simultaneously visible
- all readings are independent of the point of application of force (with sizes 1, 2 and 4)
- safe handling due to ergonomically designed handle (resistant to oils, grease, fuels, brake fluid and skydrol)
- 3 certificates (torque indicating/clicking in accordance with DIN EN ISO 6789-2:2017, angle)
- in sturdy plastic box (size 40-100 in steel box)
- design patent, patent
- supplied with SENSOMASTER 4 software, USB cable, 4 AAA/LR03 micro-batteries, 1.5 V. AAA, 1.2 V, micro NIMH rechargeable batteries can be used
- display resolution, angle 0.1°
- display deviation value, angle ±1%, ±1 digit
- display resolution, torque ≤ 60 N-m: 0.01 N-m; > 60 N-m: 0.1 N-m
- display deviation value, torque ±2%, ±1 digit



Part No.	Size	Torque Range (ft lb)	Torque Range (in lb)	Torque Range (N m)	Mount Size (mm)	OAL (mm)	Weight (g)
96 50 09 01	1	0.7-7.5	9-90	1-10	9 x 12	226	370
96 50 09 02	2	1.5-15	18-180	2-20	9 x 12	226	380
96 50 09 04	4	3-30	36-360	4-40	9 x 12	252	420
96 50 09 06	6	4.5-45	54-540	6-60	9 x 12	393	810
96 50 09 10	10	7.4-75	90-900	10-100	9 x 12	466	1085
96 50 09 20	20	15-150	180-1800	20-200	14 x 18	547	1361
96 50 09 40	40	30-300	360-3600	40-400	14 x 18	687	1765
96 50 09 65	65	48-480	580-5800	65-650	22 x 28	890	3222
96 50 09 80	80	60-600	720-7200	80-800	22 x 28	1158	4572
96 50 01 00	100	74-750	900-9000	100-1000	22 x 28	1343	4990

STAHLWILLE ELECTROMACHANICAL TORQUE WRENCH ANGLE-CONTROLLED MANOSKOP® 714R WITH REVERSIBLE RATCHET INSERT TOOL

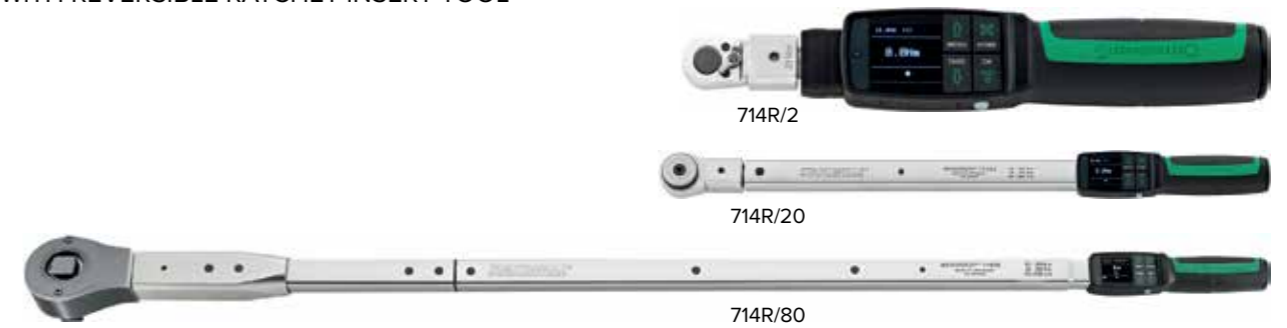

Part No.	Size	Torque Range (ft lb)	Torque Range (in lb)	Torque Range (N m)	Mount Size (mm)	Drive Size (in)	OAL (mm)	Weight (g)
96 50 10 01	1	0.7-7.5	9-90	1-10	9 x 12	1/4	269	432
96 50 10 02	2	1.5-15	18-180	2-20	9 x 12	1/4	269	442
96 50 10 04	4	3-30	36-360	4-40	9 x 12	1/4	295	482
96 50 10 06	6	4.5-45	54-540	6-60	9 x 12	3/8	427	965
96 50 10 10	10	7.4-75	90-900	10-100	9 x 12	1/2	500	1232
96 50 10 20	20	15-150	180-1800	20-200	14 x 18	1/2	594	1663
96 50 10 40	40	30-300	360-3600	40-400	14 x 18	3/4	737	2275
96 50 10 65	65	48-480	580-5800	65-650	22 x 28	3/4	980	5137
96 50 10 80	80	60-600	720-7200	80-800	22 x 28	3/4	1253	6187
96 50 11 00	100	73-735	885-8850	100-1000	22 x 28	3/4	1438	6905

STAHLWILLE ELECTRONIC TORQUE WRENCH ANGLE-CONTROLLED SENSOTORK® 713R WITH REVERSIBLE RATCHET INSERT TOOL



- simple, flexible operation thanks to operator guidance on large-format display
- very broad measuring range (5% to 100% of rated value)
- supplied with insert tool reversible ratchet
- more insert tools
- QuickRelease safety lock
- for clockwise and anticlockwise torquing
- measurements independent of the point of application of force
- units of measurement: N-m, ft-lb, in-lb
- advance warning points programmable for visual, tactile and acoustic signals
- backlit display aids evaluation of the tightening operation (traffic-light colours)
- insert tool lengths can be individually set
- maintenance friendly due to easy adjustment and automatic reminder of next calibration date
- repeated joints can be collated to form a single menu-guided

- tightening jobs are stored with a timestamp
- individual identification markings possible
- password protection to prevent inadvertent changes and make the tool tamper-proof
- meets requirements of DKD-R 3-7, Class 2
- with 2 certificates (torque in accordance with DIN EN ISO 6789-2:2017/angle)
- in sturdy plastic box (size 40 in tough steel box)
- supplied with two 1.5 V AA batteries. AA/LR6, 1.2 V NIMH rechargeable cells may also be used
- fully automated calibration (torque) using perfectControl® calibrating unit No 7794-2. Readjustment does not require disassembly.
- registered design
- display deviation value ± 1%
- Torque and angle simultaneously displayed



Part No.	Size	Torque Range (ft lb)	Torque Range (N m)	Mount Size (mm)	Drive Size (in)	OAL (mm)	Weight (g)
96 50 16 06	6	2.5-44	3-60	9 x 12	3/8	378	856
96 50 16 20	20	7-148	10-200	14 x 18	1/2	608	1552
96 50 16 40	40	15-296	20-400	14 x 18	3/4	838	2332

STAHLWILLE ELECTRONIC TORQUE WRENCH SENSOTORK® 712R/6 WITH REVERSIBLE RATCHET INSERT TOOL



- Same features as 713R without angle function



Part No.	Size	Torque Range (ft lb)	Torque Range (N m)	Mount Size (mm)	Drive Size (in)	OAL (mm)	Weight (g)
96 50 15 06	6	2.5-44	3-60	9 x 12	3/8	378	856

### STAHLWILLE RATCHET INSERT TOOLS RATCHET QUICKRELEASE 725QR

- reversible
- with QuickRelease safety lock
- size 4: 22 teeth
- sizes 5 and 10: 30 teeth



Part No.	Size	Drive Size (in)	Mount Size (mm)	max N m	Weight (g)
58 25 30 04	4	1/4	9 x 12	40	50
58 25 30 05	5	3/8	9 x 12	100	130
58 25 30 10	10	1/2	9 x 12	100	141

### STAHLWILLE RATCHET INSERT TOOLS BIT RATCHET 725B

- reversible
- with inside hexagon, 1/4" or 5/16", DIN 3126/ISO 1173 D 6.3 or D8
- for direct acceptance of bits 1/4" or 5/16" outside hexagon C 6.3 (size 4: 22 teeth, size 5: 30 teeth)
- internal hex drive with a collar-thrust spring
- bits are easy to insert, lock securely in position and can be removed just as easily; even hex bits with a wide groove (Type E, DIN 3126/ISO 1173)



Part No.	Size	Drive Size (in)	Mount Size (mm)	Weight (g)
58 25 50 04	4	1/4	9 x 12	54
58 25 50 05	5	5/16	9 x 12	117

### STAHLWILLE RATCHET INSERT TOOLS SQUARE DRIVE RATCHET 734



Part No.	Size	Drive Size (in)	Mount Size (mm)	max N m	Weight (g)
58 24 00 04	4	1/4	9 x 12	40	71
58 24 00 05	5	3/8	9 x 12	80	76
58 24 00 10	10	1/2	9 x 12	100	82

### STAHLWILLE INSERT TOOLS RING SPANNER 732/10



Part No.	Size (mm)	Mount Size (mm)	Weight (g)
58 22 10 07	7	9 x 12	37
58 22 10 08	8	9 x 12	40
58 22 10 10	10	9 x 12	44
58 22 10 11	11	9 x 12	41
58 22 10 12	12	9 x 12	49
58 22 10 13	13	9 x 12	55
58 22 10 14	14	9 x 12	52
58 22 10 15	15	9 x 12	52
58 22 10 16	16	9 x 12	54
58 22 10 17	17	9 x 12	59
58 22 10 18	18	9 x 12	56
58 22 10 19	19	9 x 12	65
58 22 10 21	21	9 x 12	71
58 22 10 22	22	9 x 12	74

### STAHLWILLE RATCHET INSERT TOOL RATCHET 725/4

- reversible
- 22 teeth



Part No.	Size	Drive Size (in)	Mount Size (mm)	max N m	Weight (g)
58 25 40 04	4	1/4	9 x 12	40	62

### STAHLWILLE RATCHET INSERT TOOLS RATCHET FINE TOOTH 735

- reversible
- 60 teeth
- \* also available as clockwise only



Part No.	Size	Drive Size (in)	Mount Size (mm)	max N m	Weight (g)
58 25 00 05	5	3/8	9 x 12	100	150
58 25 00 10	10*	1/2	9 x 12	100	147

### STAHLWILLE INSERT TOOLS RATCHET QUICKRELEASE 725QR

- reversible
- with QuickRelease safety lock
- 36 teeth



Part No.	Size	Drive Size (in)	Mount Size (mm)	Weight (g)
58 25 30 20	20	1/2	14 x 18	325

### STAHLWILLE RATCHET INSERT TOOLS SQUARE DRIVE RATCHET 734F

with permanently attached, captive square drive



Part No.	Size	Drive Size (in)	Mount Size (mm)	Weight (g)
58 24 10 04	4	1/4	9 x 12	72
58 24 10 05	5	3/8	9 x 12	75

### STAHLWILLE INSERT TOOLS RING SPANNER 732A/10



Part No.	Size (in)	Mount Size (mm)	Weight (g)
58 62 10 16	1/4	9 x 12	36
58 62 10 20	5/16	9 x 12	37
58 62 10 24	3/8 <sup>1</sup>	9 x 12	37
58 62 10 28	7/16	9 x 12	40
58 62 10 32	1/2	9 x 12	53
58 62 10 34	9/16	9 x 12	52
58 62 10 36	5/8	9 x 12	54
58 62 10 38	11/16	9 x 12	58
58 62 10 40	3/4	9 x 12	58
58 62 10 42	13/16	9 x 12	68
58 62 10 44	7/8	9 x 12	69

### STAHLWILLE INSERT TOOLS OPEN ENDED SPANNER 731/10



Part No.	Size (in)	Mount Size (mm)	Weight (g)
58 61 10 16	1/4	9 x 12	36
58 61 10 20	5/16	9 x 12	53
58 61 10 24	3/8	9 x 12	38
58 61 10 28	7/16	9 x 12	37
58 61 10 32	1/2	9 x 12	44
58 61 10 34	9/16	9 x 12	49
58 61 10 36	5/8	9 x 12	64
58 61 10 38	11/16	9 x 12	76
58 61 10 40	3/4	9 x 12	73

### STAHLWILLE INSERT TOOLS TORX® 732TX/10



Part No.	Size	Mount Size (mm)	Weight (g)
58 29 10 06	E6	9 x 12	40
58 29 10 08	E8	9 x 12	45
58 29 10 10	E10	9 x 12	45
58 29 10 12	E12	9 x 12	50
58 29 10 14	E14	9 x 12	60

### STAHLWILLE INSERT TOOLS CROWRING 733/10



Part No.	Size (mm)	Mount Size (mm)	Weight (g)
58 23 10 10	10	9 x 12	57
58 23 10 11	11	9 x 12	55
58 23 10 12	12	9 x 12	59
58 23 10 13	13	9 x 12	55
58 23 10 14	14	9 x 12	60
58 23 10 16	16	9 x 12	65
58 23 10 17	17	9 x 12	64
58 23 10 18	18	9 x 12	74
58 23 10 19	19	9 x 12	70
58 23 10 21	21	9 x 12	88
58 23 10 22	22	9 x 12	92
58 23 10 24	24	9 x 12	75

### STAHLWILLE INSERT TOOLS RING SPANNER 732AG/10

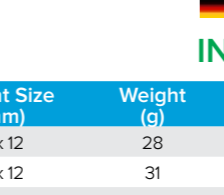

Part No.	Size (in)	Mount Size (mm)	Weight (g)
58 62 12 16	1/4	9 x 12	28
58 62 12 20	5/16	9 x 12	31
58 62 12 24	3/8	9 x 12	42
58 62 12 28	7/16	9 x 12	43
58 62 12 32	1/2	9 x 12	58
58 62 12 34	9/16	9 x 12	58
58 62 12 36	5/8	9 x 12	74

### STAHLWILLE INSERT TOOLS OPEN ENDED SPANNER 731/10



Part No.	Size (mm)	Mount Size (mm)	Weight (g)
58 21 10 07	7	9 x 12	40
58 21 10 08	8	9 x 12	39
58 21 10 09	9	9 x 12	38
58 21 10 10	10	9 x 12	42
58 21 10 11	11	9 x 12	41
58 21 10 12	12 <sup>1</sup>	9 x 12	43
58 21 10 13	13	9 x 12	45
58 21 10 14	14	9 x 12	52
58 21 10 15	15	9 x 12	51
58 21 10 16	16	9 x 12	58
58 21 10 17	17	9 x 12	60
58 21 10 18	18	9 x 12	71
58 21 10 19	19	9 x 12	74

### STAHLWILLE INSERT TOOLS RING SPANNER 732G/10

HPQ® high performance steel, gunmetal finish



Part No.	Size (mm)	Mount Size (mm)	Weight (g)
58 62 00 07	7	9 x 12	31
58 62 00 08	8	9 x 12	33
58 62 00 09	9	9 x 12	44
58 62 00 10	10	9 x 12	45
58 62 00 13	13	9 x 12	60

### STAHLWILLE INSERT TOOLS CROWRING 733A/10



Part No.	Size (in)	Mount Size (mm)	Weight (g)
58 63 10 24	3/8	9 x 12	55
58 63 10 28	7/16	9 x 12	56
58 63 10 32	1/2	9 x 12	58
58 63 10 34	9/16	9 x 12	59
58 63 10 36	5/8	9 x 12	61
58 63 10 38	11/16	9 x 12	48
58 63 10 40	3/4	9 x 12	76

### STAHLWILLE INSERT TOOLS ADAPTOR 7370/10

for using insert tools with an outer square drive of 14 x 18 mm on torque wrenches with an internal square drive of 9 x 12 mm



Part No.	Size (mm)	Mount Size (mm)	Weight (g)
58 29 00 10	14 x 18	9 x 12	118

## DESOUTTER QUALITY DIGITAL WRENCH DWTA

Aimed primarily for Quality Residual Torque checks organized in routes (Process Capability Tests) and Joint analysis for engineering purposes, the DWTA in combination with Delta 7D offers also a possibility to perform tightening strategies in restricted access conditions with a high level of precision and curves / results and statistics displayed.

Non Length Dependent Transducer thanks to double bridge strain gauge. To guarantee a tightening result independent from operator hand position +/-1% of torque reading (from 10% to 100% of torque range)



Military connector for standard transducer cable

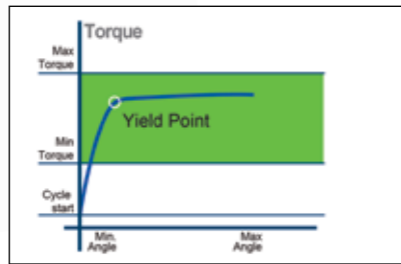

Joint analysis

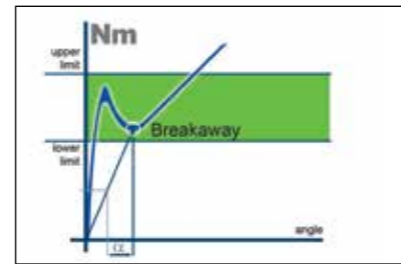

Breakaway Torque after a predefined angle rotation (a)

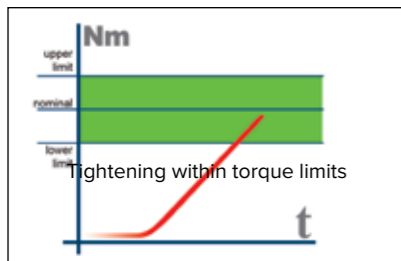

Tightening within torque limits

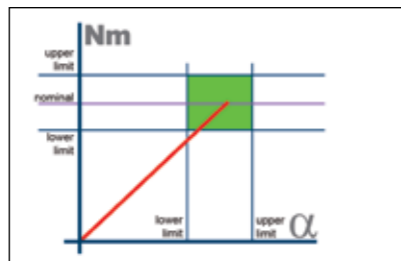

Tightening within torque and angle limits (tightening to a window)

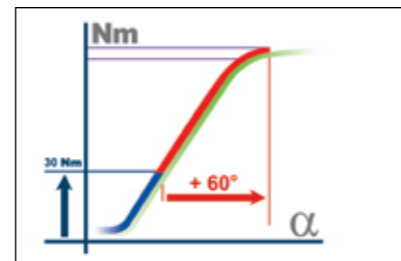

Tightening with torque and additional angle rotation (torque + angle)

Part No.	Model	Pic Ref	Torque Range		Angle	Drive		Included Ratchet	Length		Weight	
			Nm	in.lb		mm	in		kg	lb	kg	lb
615 165 760 0	DWTA 30		3-30	2.21-22.1	4	9x12	0.35x0.47	3/8	402	15.8	0.9	2.0
615 165 761 0	DWTA 150 Short		15-150	11.06-110.6	4	14x18	0.55x0.71	1/2	418	24.6	1.8	4.0
615 165 762 0	DWTA 400		40-400	29.5-295	4	14x18	0.55x0.71	3/4	1026	40.4	2.8	6.2

## DESOUTTER DELTA WRENCH DIGITAL WRENCH FOR TORQUE & ANGLE MEASUREMENT

The digital wrench integrates is a unique device and flexible solution for both production and quality strategy in tightening. Delta Wrench provides high accuracy solution for both torque and angle controlled joints tightening. Delta Wrench ensures perfect tightening operator independent thanks to automatic pre-defined PSet selection. It also includes residual torque measurement Quality strategies and traceability for a perfect quality audit with predefined routes.

- In order to provide a clear guidance to the operator during tightening, the vibrating wrench is configurable to give you an immediate feedback even in a loud environment of work.
- Non Length Dependent Transducer thanks to double bridge strain gauge. To guarantee a tightening result independent from operator hand position. Accuracy of +/-1% on Torque reading value (from 10 to 100% of the nominal torque)
- USB Port for DELTA QC free software communication for programming 200 predefined PSet or to Export result.
- Ergonomic keyboard to recall the predefined PSet
- Standard interchangeable heads and reversible ratchets
- A visual Backlight RGB colour display AND a complementary vibrating sensation system for an optimal operator guidance
- Embedded high capacity Li-Ion battery
- All models are supplied with box including reversible ratchet with TAG and Delta QC Free Version (Batteries supplied separately)



Automatic residual point detection

Part No.	Model	Range		Angle	Drive		Included Ratchet	Length		Weight	
		Nm	ft.lb		mm	in		mm	in	kg	lb
615 935 230 0	Delta Wrench 30-AV	3-30	2.21	x	9x12	0.35x0.47	3/8	402	15.8	0.9	2.0
615 935 231 0	Delta Wrench 150-AV Short	15-150	11.06-110.6	x	14x18	0.55x0.71	1/2	418	16.5	1.0	2.2
615 935 232 0	Delta Wrench 200-AV	20-200	14.75-147.5	x	14x18	0.55x0.71	1/2	625	24.6	2	4.4
615 935 233 0	Delta Wrench 400-AV	40-400	29.5-295	x	14x18	0.55x0.71	3/4	1026	40.4	2.8	6.2
615 935 234 0	Delta Wrench 500-AV	50-500	36.88-368.8	x	21x26	0.82x1.02	3/4	1137	44.8	5.5	12.1
615 935 235 0	Delta Wrench 800-AV	80-800	59.0-590	x	Ø 28	Ø 1.1	1	1305	51.4	6.7	14.8

### DESOUTTER LI-ION BATTERY AND BATTERY CHARGER



Part No.	Description
615 936 150 0	Delta Wrench Battery
615 936 151 0	Delta Wrench Battery Charger

### DESOUTTER DELTA WRENCH ACCESSORIES REVERSIBLE RATCHET



Part No.	Mount Size (mm)	Size (in)
615 397 125 0	9 x 12	1/4
615 397 126 0	9 x 12	3/8
615 397 127 0	9 x 12	1/2
615 397 200 0	14 x 18	1/2
615 936 439 0	14 x 18 HD	3/4
615 936 441 0	21 x 26	3/4
615 397 204 0	Ø 28	1

### DESOUTTER DELTAQC SOFTWARE

Part No.	Description
615 927 651 0	DeltaQC Licensed 1 user
615 927 652 0	DeltaQC Licensed 5 users
615 927 653 0	DeltaQC Advanced 1 user
615 927 654 0	DeltaQC Advanced 5 users

DESOUTTER DELTA WRENCH ACCESSORIES **MM**  
OPEN END SPANNER



Part No.	Mount Size (mm)	Size (mm)
615 397 055 0	9 x 12	7
615 397 056 0	9 x 12	8
615 397 057 0	9 x 12	9
615 397 058 0	9 x 12	10
615 397 059 0	9 x 12	11
615 397 060 0	9 x 12	12
615 397 061 0	9 x 12	13
615 397 062 0	9 x 12	14
615 397 063 0	9 x 12	15
615 397 064 0	9 x 12	16
615 397 065 0	9 x 12	17
615 397 066 0	9 x 12	18
615 397 067 0	9 x 12	19
615 397 131 0	14 x 18	13
615 397 132 0	14 x 18	14
615 397 133 0	14 x 18	15
615 397 134 0	14 x 18	16
615 397 135 0	14 x 18	17
615 397 136 0	14 x 18	18
615 397 137 0	14 x 18	19
615 397 138 0	14 x 18	21
615 397 139 0	14 x 18	22
615 397 140 0	14 x 18	24
615 397 141 0	14 x 18	27
615 397 142 0	14 x 18	30
615 397 143 0	14 x 18	32
615 397 144 0	14 x 18	34

DESOUTTER DELTA WRENCH ACCESSORIES **MM**  
RING SPANNER



Part No.	Mount Size (mm)	Size (mm)
615 397 078 0	9 x 12	7
615 397 079 0	9 x 12	8
615 397 080 0	9 x 12	10
615 397 081 0	9 x 12	11
615 397 082 0	9 x 12	12
615 397 083 0	9 x 12	13
615 397 084 0	9 x 12	14
615 397 085 0	9 x 12	15
615 397 086 0	9 x 12	16
615 397 087 0	9 x 12	17
615 397 088 0	9 x 12	18
615 397 089 0	9 x 12	19
615 397 090 0	9 x 12	21
615 397 091 0	9 x 12	22
615 397 173 0	14 x 18	13
615 397 174 0	14 x 18	14
615 397 175 0	14 x 18	15
615 397 176 0	14 x 18	16
615 397 177 0	14 x 18	17
615 397 178 0	14 x 18	18
615 397 179 0	14 x 18	19
615 397 180 0	14 x 18	21
615 397 181 0	14 x 18	22
615 397 182 0	14 x 18	24
615 397 183 0	14 x 18	27
615 397 184 0	14 x 18	30
615 397 185 0	14 x 18	32
615 397 186 0	14 x 18	34
615 397 187 0	14 x 18	36
615 397 188 0	14 x 18	41

DESOUTTER DELTA WRENCH ACCESSORIES **MM**  
CROWRING SPANNER



Part No.	Mount Size (mm)	Size (mm)
615 397 103 0	9 x 12	10
615 397 104 0	9 x 12	11
615 397 105 0	9 x 12	12
615 397 106 0	9 x 12	13
615 397 107 0	9 x 12	14
615 397 108 0	9 x 12	16
615 397 109 0	9 x 12	17
615 397 110 0	9 x 12	18
615 397 111 0	9 x 12	19
615 397 112 0	9 x 12	21
615 397 113 0	9 x 12	22
615 397 114 0	9 x 12	24

DESOUTTER DELTA WRENCH ACCESSORIES  
BIT HOLDER



Part No.	Mount Size (mm)	Size (in)
615 397 128 0	9 x 12	1/4
615 397 129 0	9 x 12	5/16
615 397 202 0	14 x 18	5/16

DESOUTTER DELTA WRENCH ACCESSORIES **IN**  
CROWRING SPANNER



Part No.	Mount Size (mm)	Size (in)
615 397 115 0	9 x 12	3/8
615 397 116 0	9 x 12	7/16
615 397 117 0	9 x 12	1/2
615 397 118 0	9 x 12	9/16
615 397 119 0	9 x 12	5/8
615 397 120 0	9 x 12	11/16
615 397 121 0	9 x 12	3/4

DESOUTTER DELTA WRENCH ACCESSORIES  
SQUARE DRIVE RATCHET



Part No.	Mount Size (mm)	Size (in)
615 397 122 0	9 x 12	1/4
615 397 123 0	9 x 12	3/8
615 397 124 0	9 x 12	1/2
615 397 198 0	14 x 18	1/2
615 397 199 0	14 x 18	3/4

DESOUTTER DELTA WRENCH ACCESSORIES **IN**  
OPEN END SPANNER



Part No.	Mount Size (mm)	Size (in)
615 397 069 0	9 x 12	1/4
615 397 070 0	9 x 12	5/16
615 397 071 0	9 x 12	3/8
615 397 072 0	9 x 12	7/16
615 397 073 0	9 x 12	1/2
615 397 074 0	9 x 12	9/16
615 397 075 0	9 x 12	5/8
615 397 076 0	9 x 12	11/16
615 397 077 0	9 x 12	3/4
615 397 145 0	14 x 18	7/16
615 397 146 0	14 x 18	1/2
615 397 147 0	14 x 18	9/16
615 397 148 0	14 x 18	5/8
615 397 149 0	14 x 18	11/16
615 397 150 0	14 x 18	3/4
615 397 151 0	14 x 18	13/16
615 397 152 0	14 x 18	7/8
615 397 153 0	14 x 18	15/16
615 397 154 0	14 x 18	1
615 397 172 0	14 x 18	1-1/8

DESOUTTER DELTA WRENCH ACCESSORIES **IN**  
OPEN END SPANNER



Part No.	Mount Size (mm)	Size (in)
615 397 092 0	9 x 12	1/4
615 397 093 0	9 x 12	5/16
615 397 094 0	9 x 12	3/8
615 397 095 0	9 x 12	7/16
615 397 096 0	9 x 12	1/2
615 397 097 0	9 x 12	9/16
615 397 098 0	9 x 12	5/8
615 397 099 0	9 x 12	11/16
615 397 100 0	9 x 12	3/4
615 397 101 0	9 x 12	13/16
615 397 102 0	9 x 12	7/8
615 397 189 0	14 x 18	1/2
615 397 190 0	14 x 18	9/16
615 397 191 0	14 x 18	5/8
615 397 192 0	14 x 18	11/16
615 397 193 0	14 x 18	3/4
615 397 194 0	14 x 18	13/16
615 397 195 0	14 x 18	7/8
615 397 196 0	14 x 18	15/16
615 397 197 0	14 x 18	1

# Torque Adapters & Multipliers

## PROTO® DIGITAL TORQUE AND ANGLE ADAPTERS

ASME B107.300

- Torque and angle tightening with one tool: productivity improvement, digital display minimizes reading errors, and delivers high precision.
- +/-2° (rotating 90° at speed of 30° / sec) for angle accuracy.
- +/-3% clockwise or +/-4% counter clockwise for torque accuracy.
- LEDs for easy viewing of results and audible beep when desired level is reached.
- Buzzer and LED indicator for the 9 pre-settable target torques or angles.
- Five Units Selectable (N.m, ft-lb, in.lb, kg.cm, degree).
- 50 data memory for recall and joint torque-angle auditing.
- Auto Sleep after about 2 minutes idle.
- Both AAA and rechargeable batteries are compatible.



Part No.	Drive Size (in)	Torque Range (ft-lbs)	Torque Range (in-lbs)	Torque Range (Nm)	OAL (in)	Weight (lbs)	Battery Type	Storage Case
J6280TA100	3/8	5-99.5	60-1195	6.8-135	3-23/64	0.70	2 AAA included	J6310PB
J6280TA150	1/2	7.4-147.5	88-1770	10-200	3-23/64	0.70	2 AAA included	J6415PB
J6280TA250	1/2	12.5-250.7	150-3009	17-340	3-23/64	0.70	2 AAA included	J6425PB

## PROTO® DIGITAL ANGLE ADAPTER

ASME B107.300

- Digital angle value readout.
- Ultra simple use: autotest and reset upon powering on.
- Adapter magnetized so it attaches to all types of ratchets.
- +/-2° accuracy (rotating 90° at speed of 30° / sec).
- +/-2% clockwise and counter clockwise for torque accuracy.
- LEDs for easy viewing of results and audible beep when desired level is reached.
- Buzzer and LED indicator for the 9 pre-settable target torques.
- 50 data memory for recall and joint torque auditing.
- Auto Sleep after about 2 minutes idle.
- Both AAA and rechargeable batteries are compatible.



Part No.	Drive Size (in)	Torque Range (ft-lbs)	Torque Range (in-lbs)	Torque Range (Nm)	OAL (in)	Weight (lbs)	Battery Type	Storage Case
J6300TWA	-	-	-	-	2-9/32	0.50	2 AAA included	J6300PB

## PROTO® TORQUE MULTIPLIERS 750 FT-LBS

ASME B107.300

- Maximum rated input: 227 ft-lbs. (308 Nm).
- Maximum rated output: 750 ft-lbs. (1017 Nm).
- Standard torque accuracy is +/- 5% of reading.
- Reaction system: tubular reaction bar.
- Gear system: single stage planetary.



Part No.	Input Drive (in)	Output Drive (in)	Torque Ratio	Head Depth (in) (A)	Head Length (in) (B)	Handle Length (in) (L1)	OAL (in) (L)	Weight (lbs)
J6202A	1/2	3/4 Sq. Male	1:3.33	3-3/32	2-13/16	5-1/4	8-19/32	4.00
J6202ACERT	1/2	3/4 Sq. Male	1:3.33	3-3/32	2-13/16	5-1/4	8-19/32	4.00

## PROTO® TORQUE MULTIPLIERS 1200 FT-LBS

ASME B107.300

- Maximum rated input: 200 ft-lbs. (271 Nm).
- Maximum rated output: 1200 ft-lbs. (1626 Nm).
- Standard torque accuracy is +/- 5% of reading.
- Reaction system: tubular reaction bar.
- Gear system: single stage planetary.
- Angle of turn protractor: 5° increments.



Part No.	Input Drive (in)	Output Drive (in)	Torque Ratio	Head Depth (in) (A)	Head Length (in) (B)	Handle Length (in) (L1)	OAL (in) (L)	Weight (lbs)	Repair Kit
J6212	1/2	3/4 Sq. Male	1:6	4	3-15/16	14-1/8	19-19/32	9.10	J6212RD
J6212CERT	1/2	3/4 Sq. Male	1:6	4	3-15/16	14-1/8	19-19/32	9.10	J6212RD

## PROTO® TORQUE MULTIPLIERS 2200 FT-LBS

ASME B107.300

- Maximum rated input: 162 ft-lbs. (220 Nm).
- Maximum rated output: 2200 ft-lbs. (2983 Nm).
- Standard torque accuracy is +/- 5% of reading.
- Reaction system: tubular reaction bar.
- Gear system: two stage planetary.
- Angle of turn protractor: 5° increments.
- Anti-backlash device: self-contained, 3 position.



Part No.	Input Drive (in)	Output Drive (in)	Torque Ratio	Head Depth (in) (A)	Head Length (in) (B)	Handle Length (in) (L1)	OAL (in) (L)	Weight (lbs)	Repair Kit
J6222	1/2	1 Sq. Male	1:13.6	5-3/4	4-1/16	14-1/8	19-19/32	15.20	J6222RD
J6222CERT	1/2	1 Sq. Male	1:13.6	5-3/4	4-1/16	14-1/8	19-19/32	15.20	J6222RD

## PROTO® TORQUE MULTIPLIERS 3200 FT-LBS

ASME B107.300

- Maximum rated input: 173 ft-lbs. (235 Nm).
- Maximum rated output: 3200 ft-lbs. (4338 Nm).
- Standard torque accuracy is +/- 5% of reading.
- Reaction system: tubular reaction bar.
- Gear system: two stage planetary.
- Angle of turn protractor: 5° increments.
- Anti-backlash device: self-contained, 3 position.



Part No.	Input Drive (in)	Output Drive (in)	Torque Ratio	Head Depth (in) (A)	Head Length (in) (B)	Handle Length (in) (L1)	OAL (in) (L)	Weight (lbs)	Repair Kit
J6232	1/2	1 Sq. Male	1:18.5	6-1/2	4-1/16	14-1/8	19-19/32	18.30	J6232RD
J6232CERT	1/2	1 Sq. Male	1:18.5	6-1/2	4-1/16	14-1/8	19-19/32	18.30	J6232RD

# Torque Drivers

## DESOUTTER TORQUE DRIVER E-LIT SERIES

- 0.4 to 60 Nm (3.5 to 530 in. lb) - 50 to 1550 rpm



Part No.	Model	Pic Ref	Torque Range		Rotational Speed rpm	Output Drive		Weight without Battery		Voltage V
			Nm	in.lb		W	kg	lb		
<b>E-lit plus – Electronic brushless motor</b>										
615 165 415 0	ELB 2.5-1250-P	A	0.4-2.5	3.5-22	1250	Hex. 1/4 F	0.8	1.76	18	
615 165 416 0	ELB 6-900-P	A	0.8-6	71-53	900	Hex. 1/4 F	0.8	1.76	18	
615 165 440 0	ELB 6-670-P	A	0.8-6	71-53	670	Hex. 1/4 F	0.8	1.76	18	
615 165 417 0	ELB 8-670-P	A	1.5-8	13.3-70	670	Hex. 1/4 F	0.8	1.76	18	
615 165 418 0	ELB 12-600-P	A	3-12	26.5-106	570	Hex. 1/4 F	0.8	1.76	18	
<b>E-lit premium – Electronic brushless speed setting</b>										
615 165 419 0	ELS 2.5-1550-P	A	0.4-2.5	3.5-22	500-1550	Hex. 1/4 F	0.8	1.76	18	
615 165 420 0	ELS 6-1000-P	A	0.8-6	71-53	300-1000	Hex. 1/4 F	0.8	1.76	18	
615 165 605 0	ELS 8-400-P	A	1.5-8	13.3-70	120-400	Hex. 1/4 F	0.8	1.76	18	
615 165 421 0	ELS 8-800-P	A	1.5-8	13.3-70	300-765	Hex. 1/4 F	0.8	1.76	18	
615 165 825 0	ELS 8-400-P4S	A	1.5-8	13.3-70	120-400	Sq. 1/4	0.8	1.76	18	
615 165 422 0	ELS 12-600-P	A	3-12	26.5-106	250-570	Hex. 1/4 F	0.8	1.76	18	
615 165 826 0	ELS 12-400-P4S	A	3-12	26.5-106	120-400	Sq. 1/4	0.8	1.76	18	
615 165 725 0	ELS 7-360-A4S	B	1.5-7	13.3-62	120-360	Sq. 1/4	1.2	2.6	18	
615 165 628 0	ELS 7-880-A	B	1.5-7	13.3-62	400-880	Hex. 1/4 F	1.2	2.6	18	
615 165 888 0	ELS 7-880-A10S	B	1.5-7	13.3-62	400-880	Sq. 3/8	1.2	2.6	18	
615 165 629 0	ELS 15-480-A	B	5-15	44.2-133	200-480	Sq. 3/8	1.2	2.6	18	
615 165 839 0	ELS 15-480-A4S	B	5-15	44.2-133	200-480	Sq. 1/4	1.2	2.6	18	
615 165 630 0	ELS 30-300-A	C	10-30	88.5-265	100-300	Sq. 3/8	1.5	3.3	36	
615 165 631 0	ELS 45-180-A	C	20-45	177-398	50-180	Sq. 3/8	1.5	3.3	36	
615 165 632 0	ELS 60-160-A	D	25-60	220-530	50-160	Sq. 1/2	1.97	4.33	36	
<b>E-lit wireless – Communication</b>										
615 166 100 0	ELC 6-1000-P-W	A	0.8-6	71-53	300-1000	Hex. 1/4 F	0.9	1.76	18	
615 166 101 0	ELC 8-400-P-W	A	1.5-8	13.3-70	120-400	Hex. 1/4 F	0.9	1.76	18	
615 166 102 0	ELC 8-800-P-W	A	1.5-8	13.3-70	300-765	Hex. 1/4 F	0.9	1.76	18	
615 166 103 0	ELC 12-600-P-W	A	3-12	26.5-106	250-570	Hex. 1/4 F	0.9	1.76	18	
615 166 104 0	ELC7-360-A4S-W	B	3-7	13.3-62	150-360	Sq. 1/4	1.2	2.6	18	
615 166 105 0	ELC7-880-A-W	B	3-7	13.3-62	400-880	Sq. 3/8	1.2	2.6	18	
615 166 106 0	ELC15-480-A-W	B	5-15	44.2-133	200-480	Sq. 3/8	1.2	2.6	18	
615 166 107 0	ELC30-300-A-W	C	10-30	88.5-265	100-300	Sq. 3/8	1.5	3.3	36	
615 166 108 0	ELC45-180-A-W	C	20-45	177-398	50-180	Sq. 3/8	1.5	3.3	36	
615 166 109 0	ELC60-160-A-W	D	25-60	220-530	50-160	Sq. 1/2	2	4.3	36	

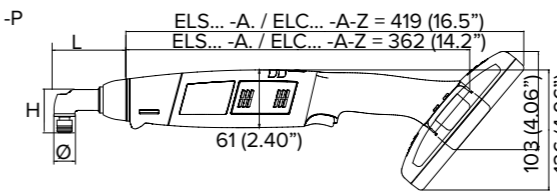
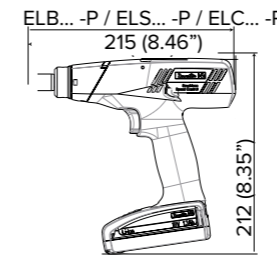

Model	H		L		Ø	
	mm	in	mm	in	mm	in
ELS7 / ELC7	45.5	1.79	75.7	2.98	22	0.87
ELS15 / ELC15	41.5	1.63	75.7	2.98	22	0.87
ELS30 / ELC30	45.5	1.79	134.2	5.28	28	1.10
ELS45 / ELC45	51.1	2.01	144.6	5.69	35	1.38
ELS60 / ELC60	57.1	2.25	158.5	6.24	40	1.57

Accessories optional	Pistol	Angle Head 18V	Angle Head 36V	ELC-W Tools	Part No.
<b>Battery Type</b>					
1 Li-ion Battery 18V 2.1 Ah – 0.35 kg (0.77lb)	x	x		x	615 812 099 0
2 Li-ion Battery 18V 4.2 Ah – 0.60 kg (1.32lb)	x	x		x	615 812 100 0
3 Li-ion Battery 36V 2.1 Ah – 0.60 kg (1.32lb)			x	x	615 811 924 0
<b>Chargers</b>					
4 Charger Universal 18 / 36V	x	x	x	x	615 813 270 0
• Power Cord C13-C14 L=0.3m (daisy chain cable)	x	x	x	x	615 813 383 0
<b>Protective Covers – Tools</b>					
5 For Pistol – Clear	x			x	615 396 870 0
5 For Pistol – Black	x			x	615 211 030 0
5 For Pistol – Blue	x			x	615 211 031 0
5 For Pistol – Red	x			x	615 211 032 0
5 For Pistol – Grey	x			x	615 211 033 0
5 For Body angle head – Black		x	x	x	615 211 004 0
5 For Body angle head – Blue		x	x	x	615 211 025 0
5 For Body angle head – Red		x	x	x	615 211 026 0
5 For Body angle head – Grey		x	x	x	615 211 027 0
6 For Angle < 15Nm – Black		x		x	615 397 672 0
6 For Angle 30Nm – Black			x	x	615 573 214 0
6 For Angle 45Nm – Black			x	x	615 573 215 0
6 For Angle 60Nm – Black			x	x	615 211 005 0
<b>Protective Covers – Battery</b>					
7 For Battery 18V 2.1Ah – Clear	x	x		x	615 396 871 0
7 For Battery 18V 2.1Ah – Black	x	x		x	615 211 041 0
7 For Battery 18V 2.1Ah – Blue	x	x		x	615 211 042 0
7 For Battery 18V 2.1Ah – Red	x	x		x	615 211 043 0
7 For Battery 18V 2.1Ah – Grey	x	x		x	615 211 044 0
7 For Battery 18V 4.2Ah / 36V 2.1Ah – Clear	x	x	x	x	615 396 872 0
7 For Battery 18V 4.2Ah / 36V 2.1Ah – Black	x	x	x	x	615 211 046 0
7 For Battery 18V 4.2Ah / 36V 2.1Ah – Blue	x	x	x	x	615 211 047 0
7 For Battery 18V 4.2Ah / 36V 2.1Ah – Red	x	x	x	x	615 211 048 0
7 For Battery 18V 4.2Ah / 36V 2.1Ah – Grey	x	x	x	x	96 03 14 48
<b>Miscellaneous</b>					
• Kit Overmould Presto (x10 pcs)					615 211 057 5
8 Speed Setting Module (ELS/ELC version)	x	x	x	x	615 396 829 0
9 Side handle – Pistol	x			x	615 396 757 0
10 Suspension bail – Pistol	x			x	443 703
11 Kit colour rings – Pistol (7 colors: white, yellow, orange, green, blue, purple, grey)	x			x	615 396 742 5
11 Kit colour rings – Angle tools (8 colors: white, yellow, orange, green, blue, purple, grey, black)		x	x	x	615 970 114 5
12 Kit Nose Crowfoot	x			x	615 810 695 0
13 eDOCK + Battery data interface	x	x	x	x	615 813 400 0
• E-LIT CONFIG software	x	x	x	x	-
• CVI CONFIG software				x	-
<b>Desoutter Tool Holders</b>					
14 DTH-42	x			x	107892
15 DTH-90	x			x	615 812 119 0
16 DTH TWIN (single) without rail		x	x	x	615 811 411 0
17 DTH TWIN rail kit with 2 Twin holders		x	x	x	615 811 412 5
18 DTH TWIN stand kit with 2 Twin holders		x	x	x	615 811 413 5



## DESOUTTER TORQUE SCREWDRIVER B-FLEX – PISTOL GRIP

- 1.5 to 17 Nm (1.1 to 12.5 ft. lb) - 10 to 1800 rpm
- Battery not included in standard offering
- Battery 18V, 2.1Ah - Weight: 0.35kg (0.77lb) / 18V, 4.2Ah & 36V, 2.1Ah - Weight: 0.60kg (1.32lb)

Accessories  
see page 629



Part No.	Model	Pic Ref	Output Drive	Torque Range			Rotational Speed			Weight without Battery		Voltage		
				min	rec	max	18V	36V	kg	lb				
<b>B-FLEX – Transducerized battery tool</b>														
615 165 899 0	EPB 8-1800-4Q	A	Hex.1/4	1.5	7	8	1.1	5.2	5.9	900	1800	1	2.2	18/36
615 165 903 0	EPB 8-1800-10S	B	Sq.3/8	1.5	7	8	1.1	5.2	5.9	900	1800	1	2.2	18/36
615 165 978 0	EPB14-900-4Q	A	Hex.1/4	4	12	14	2.4	8.8	10.3	540	940	1	2.2	18/36
615 165 977 0	EPB14-900-10S	B	Sq.3/8	4	12	14	2.4	8.8	10.3	540	940	1	2.2	18/36
615 165 905 0	EPB 17-700-4Q	A	Hex.1/4	7	15	17	5.2	11	12.5	400	700	1	2.2	18/36
615 165 901 0	EPB 17-700-10S	B	Sq.3/8	7	15	17	5.2	11	12.5	400	700	1	2.2	18/36
<b>B-FLEX – Advanced</b>														
615 165 972 0	EPBA 8-1800-4Q	A	Hex.1/4	1.5	7	8	1.1	5.2	5.9	900	1800	1	2.2	18/36
615 165 971 0	EPBA 8-1800-10S	B	Sq.3/8	1.5	7	8	1.1	5.2	5.9	900	1800	1	2.2	18/36
615 165 974 0	EPBA14-900-4Q	A	Hex.1/4	4	12	14	2.4	8.8	10.3	540	940	1	2.2	18/36
615 165 973 0	EPBA14-900-10S	B	Sq.3/8	4	12	14	2.4	8.8	10.3	540	940	1	2.2	18/36
615 165 976 0	EPBA 17-700-4Q	A	Hex.1/4	7	15	17	5.2	11	12.5	400	700	1	2.2	18/36
615 165 975 0	EPBA 17-700-10S	B	Sq.3/8	7	15	17	5.2	11	12.5	400	700	1	2.2	18/36

Model	L		A		B		C	
	mm	in	mm	in	mm	in	mm	in
EPB 8-1800-4Q	227	8.94	32	1.26	206	8.11	38	1.5
EPB 8-1800-10S	227	8.94	32	1.26	206	8.11	38	1.5
EPB 14-900-4Q	227	8.94	32	1.26	206	8.11	38	1.5
EPB 14-900-10S	227	8.94	32	1.26	206	8.11	38	1.5
EPB 17-700-4Q	227	8.94	32	1.26	206	8.11	38	1.5
EPB 17-700-10S	227	8.94	32	1.26	206	8.11	38	1.5



## DESOUTTER TORQUE SCREWDRIVER B-FLEX – ANGLE HEAD

- 5 to 95 Nm (3.7 to 70 ft. lb) - 10 to 900 rpm
- Battery not included in standard offering
- Battery 36V, 2.1Ah - Weight: 0.60 kg

Accessories  
see page 629



Part No.	Model	Pic Ref	Square Drive	Torque Range			Rotational Speed			Weight without Battery		Voltage		
				min	rec	max	18V	36V	kg	lb				
<b>B-FLEX – Transducerized battery tool</b>														
615 165 731 0	EAB 15-900	•	1/4	5	13	15	3.7	9.6	11	900	155	3.42	36	18/36
615 165 732 0	EAB 26-560	A	3/8	5	24	26	3.7	18	19	560	165	3.64	36	18/36
615 165 733 0	EAB 32-410	A	3/8	7	30	32	5.2	22	24	410	165	3.64	36	18/36
615 165 734 0	EAB 45-330	B	3/8	9	40	45	6.6	30	33	330	176	3.88	36	18/36
615 165 735 0	EAB 50-450	B	3/8	9	45	50	6.6	33	37	450	2.04	4.50	36	18/36
615 165 736 0	EAB 60-370	B	1/2	10	55	60	7.4	41	44	370	2.35	5.18	36	18/36
615 165 737 0	EAB 75-300	C	1/2	12	70	75	8.8	52	55	300	2.94	6.48	36	18/36
615 165 738 0	EAB 95-240	C	1/2	19	90	95	14	66	70	240	2.98	6.57	36	18/36
<b>B-FLEX – Advanced</b>														
615 165 961 0	EABA15-900	•	1/4	5	13	15	3.7	9.6	11	900	155	3.42	36	18/36
615 165 962 0	EABA26-560	A	3/8	5	24	26	3.7	18	19	560	165	3.64	36	18/36
615 165 963 0	EABA32-410	A	3/8	7	30	32	5.2	22	24	410	165	3.64	36	18/36
615 165 964 0	EABA45-330	B	3/8	9	40	45	6.6	30	33	330	176	3.88	36	18/36
615 165 965 0	EABA50-450	B	3/8	9	45	50	6.6	33	37	450	2.04	4.50	36	18/36
615 165 966 0	EABA60-370	B	1/2	10	55	60	7.4	41	44	370	2.35	5.18	36	18/36
615 165 967 0	EABA75-300	C	1/2	12	70	75	8.8	52	55	300	2.94	6.48	36	18/36
615 165 968 0	EABA95-240	C	1/2	19	90	95	14	66	70	240	2.98	6.57	36	18/36

Model	L		H		H		Ø A		Ø B	
	mm	in	mm	in	mm	in	mm	in	mm	in
EAB 15-900	470	18.5	10.2	0.40	33.8	1.33	22	0.87	370	1.46
EAB 26-560	496	19.5	12.0	0.47	45.7	1.80	28	1.10	370	1.46
EAB 32-410	496	19.5	12.0	0.47	45.7	1.80	28	1.10	370	1.46
EAB 45-330	506	19.9	12.0	0.47	51.0	2.00	35	1.38	370	1.46
EAB 50-450	546	21.5	12.0	0.47	51.0	2.00	35	1.38	370	1.46
EAB 60-370	559	22.0	11.9	0.468	57.0	2.20	40	1.57	410	1.61
EAB 75-300	582	22.9	17.5	0.69	60.4	2.38	45	1.77	48.5	1.91
EAB 95-240	582	22.9	17.5	0.69	60.4	2.38	45	1.77	48.5	1.91

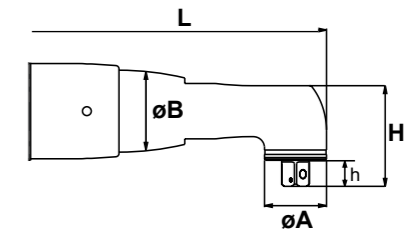

## DESOUTTER TORQUE SCREWDRIVER B-FLEX – QRX

- 5 to 95 Nm (3.7 to 70 ft. lb) - 10 to 560 rpm
- Advanced Multi Applications Tool: Possibility to use the same tool for multiple applications
- Real Time Pset selection for the selected Quickrelease accessory with RFID technology
- \*Weight without battery
- All tools are powered by a battery pack 36V 2.1Ah
- Battery pack weight: 560g / 1.23 lb



Part No.	Model	Pic Ref	Torque Range			Rotational Speed		Weight*	
			min Nm	rec Nm	max Nm	rpm	kg	lb	
615 166 080 0	EABA26-560 QRX		5	24	26	560	2.04	4.50	
615 166 081 0	EABA32-410 QRX		7	30	32	410	2.04	4.50	
615 166 082 0	EABA45-330 QRX		9	40	45	330	2.21	4.87	
615 166 083 0	EABA50-450 QRX		9	45	50	450	2.49	5.49	
615 166 084 0	EABA60-370 QRX		10	55	60	370	2.82	6.22	
615 166 085 0	EABA75-300 QRX		12	70	75	300	3.42	7.54	
615 166 086 0	EABA95-240 QRX		19	90	95	240	3.46	7.63	

## DESOUTTER TORQUE SCREWDRIVER BLRTA

- 10 to 25 Nm (7.4 to 18.4 ft.lb) - 1520 to 2350 rpm
- Boost Productivity by reducing cycle time, improving joint quality and providing process quality
- Boost Flexibility: Free of cable management, free of reaction arm, reduced total cost of ownership
- Boost the uptime of the operator and tool

Accessories see page 629



Description	Standalone Version
Wifi Communication	N/A
Programming on the tool	x
Pset	6
No. of step in Pset	1
Assembly process	N/A
Results	10 000 with CVI analyzer
Tightening Curve	N/A
Disconnected mode	N/A

Part No.	Model	Pic Ref	Output Drive	Output Retaining Type	Torque Range				Rotational Speed		Length mm	Length in	Weight kg	Weight lb	Voltage V
					min Nm	max Nm	min ft.lb	max ft.lb	18V	36V					
615 166 023 0	BLRTA025-2350-10S	A	Sq 3/8	Through hole	6	25	4.4	18.4	1520	2350	233	9.17	1.2	2.6	18/36
615 166 024 0	BLRTA025-2350-4Q	B	Hex.1/4	Quick change chuck	6	25	4.4	18.4	1520	2350	233	9.17	1.2	2.6	18/36

Accessories optional	Part No.		
	EAB/QRX	EPB/EPBA	BLRTA
<b>Battery Type</b>			
1 Li-Ion Battery 18V 2.1 Ah - 0.35 kg (0.77lb)		615 812 099 0	615 812 099 0
2 Li-Ion Battery 18V 4.2 Ah - 0.60 kg (1.32lb)		615 812 100 0	615 812 100 0
3 Li-Ion Battery 36V 2.1 Ah - 0.60 kg (1.32lb)	615 811 924 0	615 811 924 0	615 811 924 0
<b>Charger</b>			
4 Charger Universal 18 / 36V		615 813 270 0	615 813 270 0
• Power Cord C13-C14 L=0.3m (daisy chain cable)		615 813 383 0	615 813 383 0
<b>Protective Covers – Tools</b>			
5 For Angle head EAB 15		615 211 003 0	
5 For Angle head EAB 26/32		615 573 207 0	
5 For Angle head EAB 45/50		615 573 208 0	
5 For Angle head EAB 60		615 573 209 0	
5 For Angle head EAB 75/95		615 573 210 0	
6 Pistol protective cover Black		615 211 019 0	
<b>Protective Covers – Battery</b>			
7 For Battery 18V 2.1Ah - Clear		615 396 871 0	615 396 871 0
7 For Battery 18V 2.1Ah - Black		615 211 041 0	615 211 041 0
7 For Battery 18V 2.1Ah - Blue		615 211 042 0	615 211 042 0
7 For Battery 18V 2.1Ah - Red		615 211 043 0	615 211 043 0
7 For Battery 18V 2.1Ah - Grey		615 211 044 0	615 211 044 0
7 For Battery 18V 4.2Ah / 36V 2.1Ah - Clear	615 396 872 0	615 396 872 0	615 396 872 0
7 For Battery 18V 4.2Ah / 36V 2.1Ah - Black	615 211 046 0	615 211 046 0	615 211 046 0
7 For Battery 18V 4.2Ah / 36V 2.1Ah - Blue	615 211 047 0	615 211 047 0	615 211 047 0
7 For Battery 18V 4.2Ah / 36V 2.1Ah - Red	615 211 048 0	615 211 048 0	615 211 048 0
7 For Battery 18V 4.2Ah / 36V 2.1Ah - Grey	615 211 049 0	615 211 049 0	615 211 049 0
<b>Miscellaneous</b>			
8 Nose crowfoot adapter for EPB		615 565 518 0	
9 E-dock	615 811 976 0	615 811 976 0	615 811 976 0
10 Side handle		615 397 016 0	
<b>Desoutter Tool holster</b>			
11 DTH TWIN (single) without rail		615 811 411 0	
12 DTH TWIN rail kit with 2 Twin holders		615 811 412 5	
13 DTH TWIN stand kit with 2 Twin holders		615 811 413 5	
14 DTH90		615 812 119 0	615 812 119 0





# Torque Nutrunners

## DESOUTTER PISTOL GRIP ELECTRIC NUTRUNNERS – CVI3

- 0.5 to 40 Nm (0.11 to 9 ft.lb) - 680 to 2000 rpm
- CVI II Adapter needed



Accessories see page 631

Part No.	Model	Pic Ref	Output Drive	Torque Range					Rotational Speed	Length		Weight		
				min Nm	Rec Nm	max Nm	min ft.lb	Rec ft.lb		max ft.lb	rpm	mm	in	kg
615 166 198 0	ERP5	A	Hex. 1/4 F	0.5	5	5	0.11	1.12	1.12	2000	222	8.7	1.1	2.4
615 166 199 0	ERP20	B	Hex. 1/4 F	3	20	20	0.67	4.5	4.5	1540	232	9.1	1.2	2.6
615 166 200 0	ERP30	B	Sq. 3/8	5	30	30	1.12	6.7	6.7	1070	228	9.0	1.2	2.6
615 165 263 0	ERP40	C	Sq. 3/8	6	40	40	1.35	9	9	680	263	10.4	2.1	4.6
615 166 202 0	ERP5TC	D	Hex. 1/4 F	0.5	5	5	0.11	1.12	1.12	2000	248	9.8	2.5	5.5
615 166 203 0	ERP20TC	D	Hex. 1/4 F	3	20	20	0.67	4.5	4.5	1540	258	10.2	2.6	5.7

## DESOUTTER ELECTRIC TRANSDUCERIZED HIGH TORQUE NUTRUNNERS – CVI3

- 75 to 1700 Nm (55 to 1253 ft.lb) - 85 to 822 rpm
- ERS / ERPHT Adaptor necessary



Part No.	Model	Pic Ref	Output Drive	Torque Range				Max Rundown Torque	Speed	Gearbox Diameter		Length		Weight		Spline
				min Nm	max Nm	min ft.lb	max ft.lb			mm	in	mm	in	kg	lb	
615 165 883 0	ERP250	A	3/4	75	250	55	184	18	822	54	2.13	355	13.9	5.1	11.2	3
615 165 884 0	ERP500	B	3/4	150	500	110	368	37	347	67	2.64	390	15.3	5.8	12.8	4
615 165 885 0	ERP750	C	1	225	750	165	553	56	245	67	2.64	410	16.1	6.2	13.7	5
615 165 886 0	ERP1000	C	1	300	1000	221	737	75	205	67	2.64	420	16.5	6.4	14.1	5
615 165 887 0	ERP1700	•	1	510	1700	376	1253	127	85	84	3.31	455	17.9	8.3	18.3	9



Reaction Bars	Spline	1 Straight	2 S-Type	3 L-Type Aluminium	4 Square	5 Sliding Drive	6 Sliding Drive Extended C-C	7 Suspension Bail	8 Side Handle
ERP250	3	615 812 097 5	615 812 068 5	615 812 072 5	615 812 057 5	615 812 113 5	-	615 812 123 0	615 576 085 0
ERP500	4	615 812 054 5	615 812 069 5	615 812 073 5	615 812 058 5	615 812 062 5	615 812 063 5	615 812 123 0	615 576 085 0
ERP750 / ERP1000	5	615 812 055 5	615 812 070 5	-	615 812 059 5	615 812 064 5	615 812 065 5	615 812 123 0	615 576 085 0
ERP1700	9	615 812 056 5	615 812 071 5	-	615 812 060 5	615 812 066 5	615 812 067 5	615 812 123 0	615 576 085 0

Accessories optional		Part No.	
<b>Nutrunner Cable</b>			
1	Tool cable 3m (9.8ft)	615 917 461 0	
	Tool cable 5m (16ft)	615 917 462 0	
	Tool cable 10m (32.8ft)	615 917 464 0	
	Tool cable 15m (49.2ft)	615 917 465 0	
<b>Sliding Drive C-C</b>			
	C min mm (in)	C max mm (in)	
	70 (2.76)	120 (4.72)	615 812 113 5
	76 (3)	126 (4.96)	615 812 062 5
	82 (3.23)	218 (8.58)	615 812 063 5
2	80 (3.15)	125 (4.92)	615 812 064 5
	82 (3.23)	218 (8.58)	615 812 065 5
	80 (3.15)	130 (5.11)	615 812 066 5
	80 (3.15)	280 (11.0)	615 812 067 5
<b>Miscellaneous</b>			
3	ERS-ERPHT Adaptor	615 936 537 0	



### DESOUTTER ANGLE HEAD ELECTRIC NUTRUNNERS – CVI3

- 3 to 105 Nm (2.2 to 77.4 ft.lb) - 500 to 1300 rpm



Accessories  
see page 631

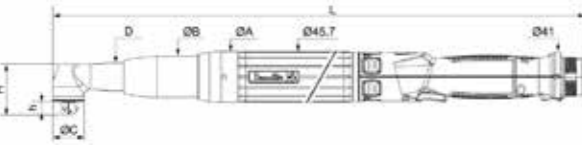

Model	h	H	Ø A	Ø B	Ø C	Ø D						
	mm	in	mm	in	mm	in						
EAD20-1300	12.0	0.47	45.5	1.79	46	1.81	37	1.46	28	1.10	25	0.98
EAD32-900	12.0	0.47	45.5	1.79	46	1.81	37	1.46	28	1.10	25	0.98
EAD50-900	12.0	0.47	51.1	2.01	46	1.81	37	1.46	35	1.38	28	1.10
EAD60-625	12.0	0.47	56.7	2.23	58	2.28	41	1.61	40	1.57	32	1.26
EAD60-625 - 1/2"	12.0	0.47	52.0	2.43	58	2.28	41	1.61	40	1.57	32	1.26
EAD70-800	12.0	0.47	56.7	2.23	58	2.28	43	1.69	40	1.57	32	1.26
EAD70-800 - 1/2"	17.0	0.67	62.0	2.43	58	2.28	43	1.69	40	1.57	32	1.26
EAD80-650	17.5	0.69	60.4	2.38	58	2.28	48	1.89	45	1.77	40	1.57
EAD105-500	17.5	0.69	60.4	2.38	58	2.28	48	1.89	45	1.77	40	1.57

Part No.	Model	Pic Ref	Square Drive	Torque Range					Rotational Speed			Length		Weight	
				min	Rec	max	min	Rec	max	rpm	mm	in	kg	lb	
			in	Nm	ft.lb	Nm	ft.lb	Nm	ft.lb	ft.lb	ft.lb	ft.lb	ft.lb	ft.lb	ft.lb
615 165 606 0	EAD20-1300		3/8	3	18	20	2.2	13.3	14.8	1300	481	19.2	1.6	3.53	
615 165 607 0	EAD32-900		3/8	5	30	32	3.7	22.1	23.6	900	481	19.2	1.6	3.53	
615 165 609 0	EAD50-900		3/8	8	45	50	5.9	33.2	40.6	900	531	20.9	2	4.41	
615 166 079 0	EAD60-625		3/8	10	55	60	7.4	41	44	625	504	19.8	2.1	4.5	
615 166 188 0	EAD60-625 - 1/2"		1/2	10	55	60	7.4	41	44	625	504	19.8	2.1	4.5	
615 165 611 0	EAD70-800		3/8	12	65	70	8.9	47.9	51.6	800	544	21.4	2.3	5.07	
615 165 882 0	EAD70-800		1/2	12	65	70	8.9	47.9	51.6	800	544	21.4	2.3	5.07	
615 165 612 0	EAD80-650		1/2	15	75	80	11.1	55.3	59	650	567	22.3	2.9	6.39	
615 165 613 0	EAD105-500		1/2	20	90	105	14.8	66.4	77.4	500	567	22.3	2.9	6.39	

### DESOUTTER ANGLE HEAD ELECTRIC NUTRUNNERS – CVI3

- 35 to 660 Nm (26 to 487 ft.lb) - 160 to 430 rpm



Accessories  
see page 631

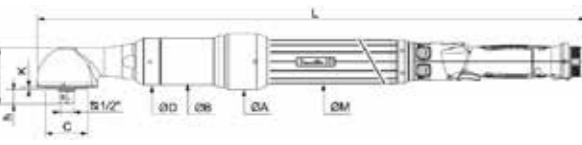

Model	h	H	Ø A	Ø B	Ø C	Ø D						
	mm	in	mm	in	mm	in						
EAD160-430	171	0.67	65	2.56	66	2.6	55	2.17	52	2.05	50	1.16
EAD200-370	23	0.91	85	3.35	66	2.6	55	2.17	52	2.05	62	2.44
EAD280-260	23	0.91	85	3.35	66	2.6	55	2.17	52	2.05	62	2.44
EAD280-370	23	0.91	85	3.35	76	2.99	55	2.17	66	2.60	62	2.44
EAD440-250	24	0.94	91	3.58	76	2.99	67	2.64	66	2.60	75	2.95
EAD660-160	331	1.3	110	4.33	76	2.99	67	2.64	66	2.60	106	4.17

Part No.	Model	Pic Ref	Square Drive	Torque Range					Rotational Speed			Length		Weight	
				min	Rec	max	min	Rec	max	rpm	mm	in	kg	lb	
			in	Nm	ft.lb	Nm	ft.lb	Nm	ft.lb	ft.lb	ft.lb	ft.lb	ft.lb	ft.lb	
615 165 681 0	EAD160-430		1/2	35	150	160	26	111	118	430	650	25.6	4.3	9.5	
615 165 682 0	EAD200-370		3/4	60	170	200	44	125	148	370	673	26.5	5.1	11.2	
615 165 683 0	EAD280-260		3/4	60	250	280	44	184	207	260	673	26.5	5.1	11.2	
615 165 684 0	EAD280-370		3/4	60	250	280	44	184	207	370	681	26.8	6.1	13.5	
615 165 685 0	EAD440-250		3/4	100	400	440	74	295	325	250	735	28.9	8.4	18.5	
615 165 686 0	EAD660-160		1	100	600	660	74	443	487	160	774	30.4	11.0	24.3	

### DESOUTTER IN-LINE ELECTRIC NUTRUNNERS – CVI3

- 3 to 75 Nm (2.2 to 57.5 ft.lb) - 800 to 1200 rpm



Accessories  
see page 631

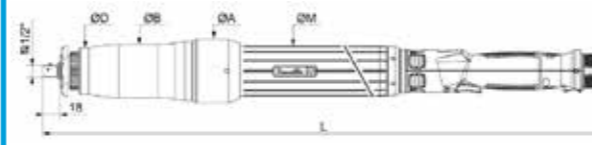

Model	Ø A		Ø B		Ø C	
	mm	in	mm	in	mm	in
EID20-1200-4Q	62	2.44	37	1.46	60	2.36
EID25-1200	62	2.44	37	1.46	60	2.36
EID32-900	62	2.44	37	1.46	60	2.36
EID44-1200	62	2.44	48	1.89	54	2.13
EID65-900	58	2.28	48	1.89	54	2.13
EID75-800	58	2.28	48	1.89	54	2.13

Part No.	Model	Pic Ref	Output Drive	Torque Range					Rotational Speed			Length		Weight	
				min	Rec	max	min	Rec	max	rpm	mm	in	kg	lb	
				in	Nm	ft.lb	Nm	ft.lb	Nm	ft.lb	ft.lb	ft.lb	ft.lb	ft.lb	
615 165 992 0	EID20-1200-4Q*		Hex. 1/4 F	3	18	21	2.2	13.3	15.5	1200	430	16.9	1.45	3.20	
615 165 614 0	EID25-1200*		Sq. 3/8	3	20	25	2.2	14.8	18.4	1200	430	16.9	1.45	3.20	
615 165 615 0	EID32-900*		Sq. 3/8	5	30	32	3.7	22.1	25.1	900	430	16.9	1.45	3.20	
615 165 616 0	EID44-1200*		Sq. 3/8	7	40	44	5.2	29.5	33.2	1200	489	19.3	2	4.41	
615 165 617 0	EID65-900		Sq. 1/2	10	60	65	7.4	44.3	47.9	900	489	19.3	2	4.41	
615 165 618 0	EID75-800		Sq. 1/2	20	70	75	14.8	51.6	57.5	800	489	19.3	2	4.41	

### DESOUTTER IN-LINE ELECTRIC NUTRUNNERS – CVI3

- 20 to 270 Nm (15 to 199 ft.lb) - 410 to 670 rpm



Accessories  
see page 631

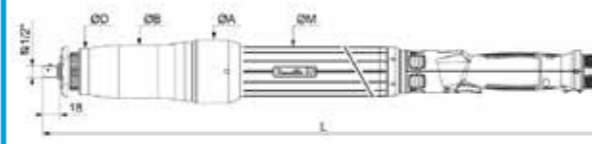

Model	Ø A		Ø B		Ø C		Ø D	
	mm	in	mm	in	mm	in	mm	in
EID120-660	66	2.60	55	2.17	52	2.05	42.0	1.65
EID170-670	72	2.83	55	2.17	66	2.60	42.0	1.65
EID270-410	76	2.99	67	2.64	66	2.60	53.5	2.11

Part No.	Model	Pic Ref	Square Drive	Torque Range					Rotational Speed			Length		Weight	
				min	Rec	max	min	Rec	max	rpm	mm	in	kg	lb	
				in	Nm	ft.lb	Nm	ft.lb	Nm	ft.lb	ft.lb	ft.lb	ft.lb	ft.lb	
615 165 677 0	EID120-660		1/2	20	110	120	15	81	89	660	583	22.9	3.3	7.3	
615 165 678 0	EID170-670		1/2	40	150	170	30	111	125	670	591	23.3	4.6	10.1	
615 165 679 0	EID270-410		3/4	60	250	270	44	184	199	410	625	24.6	6.1	13.5	



Offset Closed



Offset Open



Double start



Flush Socket tools



In line Closed



In line Open



Double start



Hold and Drive tools

## DESOUTTER NUTRUNNER EPBHT HIGH TORQUE

- 150 to 2000 Nm (36.9-995.7 ft. lb) - 3.2 to 78 rpm
- Battery not included in standard offering

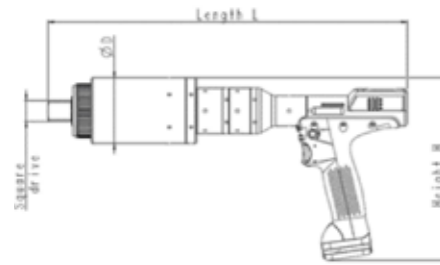

Model	Ø D		Length (L)		Height (H)	
	mm	in	mm	in	mm	in
A	48	1.9	290	11.4	206	8.1
B	48	1.9	311	12.2	206	8.1
C	48	1.9	311	12.2	206	8.1
D	63.5	2.5	426	16.8	211.5	8.3
E	83.5	3.3	460	18.1	211.5	8.3
F	80	3.1	433	17	219.5	8.6

Part No.	Model	Pic Ref	Square Drive	Torque Range				Rotational Speed		Weight without Battery		Voltage
				min Nm	max Nm	min ft.lb	max ft.lb	18V	36V	kg	lb	
<b>Pistol Version 150 Nm</b>												
STM3996000	EPBHT 150-78	A	1/2	50	150	36.9	110.6	78	1.8	3.9	36	18/36
STM4001000	EPBAHT 150-78	A	1/2	50	150	36.9	110.6	78	1.8	3.9	36	18/36
STM4006000	EPBCHT 150-78	A	1/2	50	150	36.9	110.6	78	1.8	3.9	36	18/36
<b>Pistol Version 300 Nm</b>												
STM3997000	EPBHT 300-20	B	3/4	125	300	92.2	221.2	20	2	4.4	36	18/36
STM4002000	EPBAHT 300-20	B	3/4	125	300	92.2	221.2	20	2	4.4	36	18/36
STM4007000	EPBCHT 300-20	B	3/4	125	300	92.2	221.2	20	2	4.4	36	18/36
<b>Pistol Version 500 Nm</b>												
STM3998000	EPBHT 500-10	C	3/4	300	500	239.7	368.8	10	2	4.4	36	18/36
STM4003000	EPBAHT 500-10	C	3/4	300	500	239.7	368.8	10	2	4.4	36	18/36
STM4008000	EPBCHT 500-10	C	3/4	300	500	239.7	368.8	10	2	4.4	36	18/36
<b>Pistol Version 1000 Nm</b>												
STM4146000	EPBHT 1000-6	D	1	500	1000	405.6	737.5	6	4.3	9.4	36	18/36
STM4149000	EPBAHT 1000-6	D	1	500	1000	405.6	737.5	6	4.3	9.4	36	18/36
STM4033000	EPBCHT 1000-6	D	1	500	1000	405.6	737.5	6	4.3	9.4	36	18/36
<b>Pistol Version 1500 Nm</b>												
STM4147000	EPBHT 1500-4	E	1	950	1500	700.7	1106.3	4	6.6	14.5	36	18/36
STM4150000	EPBAHT 1500-4	E	1	950	1500	700.7	1106.3	4	6.6	14.5	36	18/36
STM4034000	EPBCHT 1500-4	E	1	950	1500	700.7	1106.3	4	6.6	14.5	36	18/36
<b>Pistol Version 2000 Nm</b>												
STM4148000	EPBHT 2000-3	F	1	1350	2000	995.7	1475.1	3.2	6.1	13.4	36	18/36
STM4151000	EPBAHT 2000-3	F	1	1350	2000	995.7	1475.1	3.2	6.1	13.4	36	18/36
STM4035000	EPBCHT 2000-3	F	1	1350	2000	995.7	1475.1	3.2	6.1	13.4	36	18/36

## DESOUTTER NUTRUNNER EABX HIGH TORQUE

- 250 to 1500 Nm (184.4 to 1106.3 ft. lb) - 4 to 10 rpm
- Battery not included in standard offering

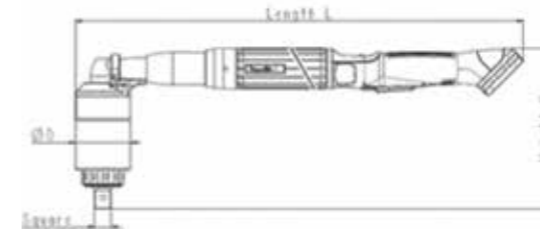

Model	Ø D		Length (L)		Height (H)	
	mm	in	mm	in	mm	in
A	48	1.9	482	19	137	5.4
B	63.5	2.5	512	20.1	183	7.2
C	83.5	3.3	529	20.8	298	11.7

Part No.	Model	Pic Ref	Square Drive	Torque Range				Rotational Speed		Weight without Battery		Voltage
				min Nm	max Nm	min ft.lb	max ft.lb	18V	36V	kg	lb	
<b>Angle Version 150 Nm</b>												
STM3999000	EABHT 500-10	A	3/4	250	500	184.4	368.8	10	2.4	5.3	36	18/36
STM4004000	EABAHT 500-10	A	3/4	250	500	184.4	368.8	10	2.4	5.3	36	18/36
STM4009000	EABCHT 500-10	A	3/4	250	500	184.4	368.8	10	2.4	5.3	36	18/36
<b>Angle Version 300 Nm</b>												
STM4000000	EABHT 1000-6	B	3/4	500	1050	368.8	774.4	4	3.6	7.9	36	18/36
STM4005000	EABAHT 1000-6	B	3/4	500	1050	368.8	774.4	4	3.6	7.9	36	18/36
STM4010000	EABCHT 1000-6	B	3/4	500	1050	368.8	774.4	4	3.6	7.9	36	18/36
<b>Angle Version 500 Nm</b>												
STM4152000	EABHT 1500-4	C	1	550	1500	405.6	1106.3	5	6.7	14.7	36	18/36
STM4153000	EABAHT 1500-4	C	1	550	1500	405.6	1106.3	5	6.7	14.7	36	18/36
STM4047000	EABCHT 1500-4	C	1	550	1500	405.6	1106.3	5	6.7	14.7	36	18/36

Please contact us for Accessories.

# Desoutter Tool Management

## E-LIT Tool management device to optimize your assembly process

- Two speed setting easily controlled by external module
- Guarantee quality and keep high productivity
- Decrease final speed to ensure tightening quality
- Avoid quality defects in your final product
- Decrease starting speed to facilitate bolt engagement

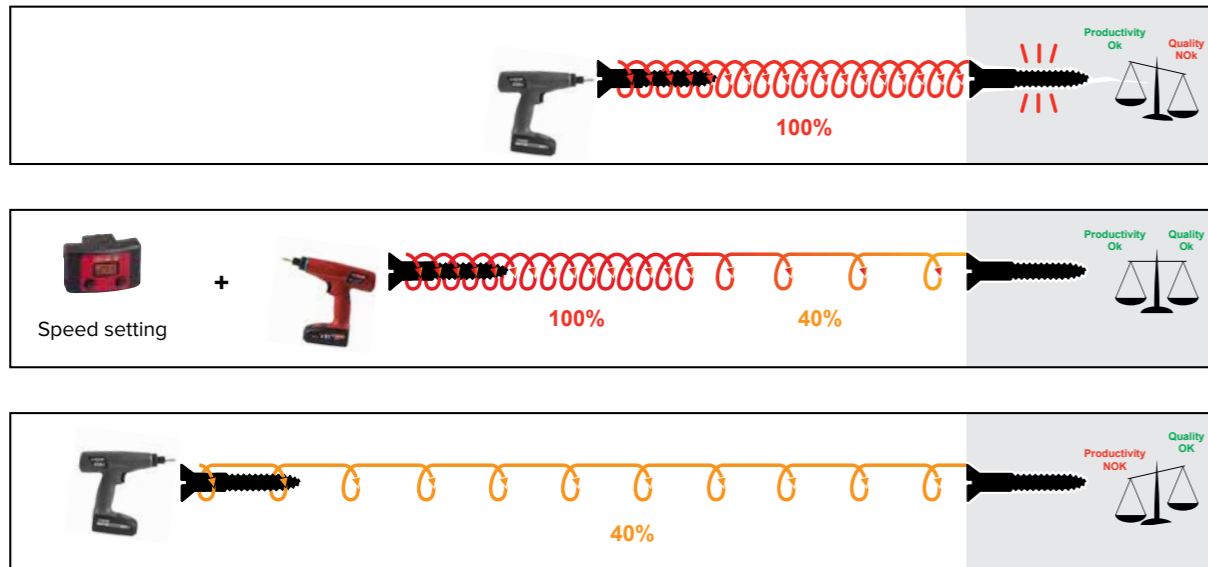

## Wireless clutch tool solution

- TU E-LIT WIFI proposes a better production follow-up, a better error proofing and a better total cost of ownership of your production line by integrating and controlling a clutch tool on the CONNECT platform.
- BETTER CONTROL OF PRODUCTION LINE by enable or disable clutch tool
- PRODUCTION QUALITY IMPROVEMENT with traceability on standard joint
- EASY INTEGRATION thanks to CONNECT platform connectivity
- Features:
  - Enable/disable tool according to production process: Batch count, Reverse mode or Open protocol, I/Os & Field bus
  - Setting adjustments to fit with application requirements: Up to 3 speeds, 4 Pset & 4 Assembly Process, Batch count
  - OK/NOK reports and prevent from FALSE OK: OK/NOK, Re-hit, Cross thread prevention
  - Traceability information for a better follow-up and analysis: Results linked with a VIN NUMBER, lock tool when memory is full (option), CVI MONITOR, ANALYZER & NET WEB compatible



# Desoutter Torque Controllers

Please visit our website for a Product PDF with detailed Features

## DESOUTTER TORQUE CONTROLLERS



Part No.	Model	Pic Ref	Consumption (Current)		Main Supply	Width		Height		Depth		Weight	
			115V	220V		mm	in	mm	in	mm	in	kg	lb
615 932 691 0	CVI3 Vision	A	4A	2A	Single-phase	175	6.9	361	14.2	310	12.2	9.3	20.5
615 932 694 0	CVI3 Vision eSTOP	A	4A	2A	Single-phase	175	6.9	361	14.2	310	12.2	9.3	20.5
615 932 697 0	TWINCVI3	B	8A	4A	Single-phase	265	10.4	361	14.2	310	12.2	15	33.1
615 932 698 0	TWINCVI3 eSTOP	B	8A	4A	Single-phase	265	10.4	361	14.2	310	12.2	15	33.1
615 932 690 0	CVI3 Function	C	4A	2A	Single-phase	175	6.9	361	14.2	310	12.2	9.3	20.5
615 932 693 0	CVI3 Function eSTOP	C	4A	2A	Single-phase	175	6.9	361	14.2	310	12.2	9.3	20.5
615 932 695 0	CVI3 Essential	D	4A	2A	Single-phase	175	6.9	361	14.2	310	12.2	9.3	20.5

Accessories optional		Part No.
<b>Fieldbus Modules</b>		
1	Profibus module	615 927 595 0
2	ProfiNet module (1 port)	615 927 596 0
3	ProfiNet module (2 ports)	615 927 597 0
3	ProfiNet IRT module (2 ports)	615 927 070 0
4	DeviceNet module	615 927 599 0
4	CC-Link module	615 927 598 0
5	EtherNet IP module	615 927 594 0
6	Modbus TCP module	615 927 615 0
<b>ePOD</b>		
7	ePOD1	615 936 075 0
7	ePOD2	615 936 076 0
7	ePOD3	615 936 077 0
7	ePOD2C	615 936 311 0
7	ePOD3C	615 936 318 0
7	ePOD4C	615 936 312 0
7	ePOD eCompass	615 936 333 0
7	ePOD Essential	615 936 836 0
<b>Other Accessories</b>		
8	Table mounting	615 397 399 5
9	Wall mounting CVI3 Function/Essential/Vision	615 397 631 5
10	Wall mounting TWINCVI3	615 811 897 0
11	Cable with 2 M8 male plugs - 0.5m (1.64ft)	615 917 626 0
	Cable with 2 M8 male plugs - 1m (3.28ft)	615 917 633 0
	Cable with 2 M8 male plugs - 2m (6.56ft)	615 917 634 0
12	Cable with 1 M8 male plugs - 5m (16.40ft)	615 917 635 0
<b>Power Cord</b>		
A	European	615 917 069 0
B	US NEMA 5-15	615 917 060 0
C	US NEMA 5-20	615 917 063 0
D	UK	615 917 070 0
E	Chinese	615 917 061 0



# Torque Testing Solutions

## ANDILOG CENTORMETER

The Andilog Centormeter range allows you to calibrate and check all of your measuring instruments: torque wrenches, torque screwdriver, screw gun, compression and tension system, force gauges, etc.

The new version of the Centormeter equipment verifies the regulating torque value of screw guns. This includes electric, pneumatic and hydraulic screw guns where rotation speed can be regulated up to 3,000 RPM.

The Centormeter traces the curve, enabling immediate visualization of the increase in the torque.

The range of sensors allows for precise measurements from 0-6Nm up to 0-1,400Nm.

Each base is equipped with a main sensor and can support additional sensors, which will be recognized without the user doing a thing.

### System includes:

- A Centormeter with one torque sensor
- Power plug
- A support base with fixing holes
- One square drive on the torque sensor
- Certificate of calibration traceable to COFRAC

### Software Options:

- RSIC software compatible: Download your data to Microsoft Excel
- Datastick compatible: Save all your data directly on a SD memory card and read your results on a computer.

### Features:

- Accuracy: 0,5% FS
- Resolution: 1/10,000 PFS
- Display current value and peak: ✓
- Units: N.m, kg.cm, lb.in, mN.m, lb.ft
- Sampling Rate: 1 000 Hertz
- Tare: ✓
- Auto-off: ✓
- Average and standard Deviation: ✓
- Low Battery Indicator: ✓
- RS232 Output: ✓
- Backlight Display: ✓
- Rechargeable Battery: ✓
- Operating Time: 8h
- Power Supply: 110V / 220V



Part No.	Capacity	Accuracy	Resolution	Square
CTRMTR-H3	3Nm	0.015Nm	1.5mNm	3/8" Female
CTRMTR-H6	6Nm	0.03Nm	1.5mNm	3/8" Female
CTRMTR-W15	15Nm	0.075Nm	1.5mNm	3/8" Female
CTRMTR-W60	60Nm	0.3Nm	6mNm	3/8" Female
CTRMTR-W150	150Nm	0.75Nm	15mNm	1/2" Female
CTRMTR-W300	300Nm	1.5Nm	30mNm	1/2" Female
CTRMTR-W650	650Nm	3.25Nm	65mNm	3/4" male
CTRMTR-W1400	1400Nm	7Nm	1.4Nm	1" male

## ADDITIONAL TORQUE SENSORS

All ANDILOG additional torque sensors can be used with the same display screen in order to measure different capacities with great precision. Each sensor is provided with a support stand, a SPIP connector to connect to the instrument and its certificate of calibration traceable to COFRAC. Mounted with a SPIP connector, the Centor meter can read and recognize automatically the sensor and load all the parameters.



Part No.	Capacity	Accuracy	Resolution	Square	Axis
CMV/TH 3	3Nm	0.015Nm	1.5mNm	3/8" F/M	Vertical
CMV/TH 6	6Nm	0.03Nm	1.5mNm	3/8" F/M	Vertical
CMV/TH 15	15Nm	0.075Nm	1.5mNm	3/8" F/M	Vertical
CMV/TH 60	60Nm	0.3Nm	6mNm	3/8" F/M	Vertical
CMV/TH 150	150Nm	0.75Nm	15mNm	1/2" F/M	Vertical
CMV/TH 300	300Nm	1.5Nm	30mNm	1/2" F/M	Vertical
CMV/TH 650	650Nm	3.25Nm	65mNm	3/4" male	Vertical
CMV/TH 1400	1400Nm	7Nm	1.4Nm	1" male	Vertical
CMH/TH 3	3Nm	0.015Nm	1.5mNm	3/8" F/M	Horizontal
CMH/TH 6	6Nm	0.03Nm	1.5mNm	3/8" F/M	Horizontal
CMH/TH 15	15Nm	0.075Nm	1.5mNm	3/8" F/M	Horizontal
CMH/TH 60	60Nm	0.3Nm	6mNm	3/8" F/M	Horizontal
CMH/TH 150	150Nm	0.75Nm	15mNm	1/2" F/M	Horizontal
CMH/TH 300	300Nm	1.5Nm	30mNm	1/2" F/M	Horizontal
CMH/TH 650	650Nm	3.25Nm	65mNm	3/4" male	Horizontal
CMH/TH 1400	1400Nm	7Nm	1.4Nm	1" male	Horizontal

## ADDITIONAL DYNAMIC TORQUE SENSORS

The dynamic torque sensors are used to check torque on assembled parts. It is placed between the screwdriver and the screw and measure directly the torque applied on the screw.



Part No.	Capacity	Accuracy	Resolution	Square
SPIP DT 6	6Nm	0.03Nm	0.6mNm	1/4"
SPIP DT 12	12Nm	0.06Nm	1.2mNm	1/4"
SPIP DT 24	24Nm	0.1Nm	2.4mNm	3/8"
SPIP DT 60	60Nm	0.3Nm	6mNm	3/8"
SPIP DT 150	150Nm	0.75Nm	15mNm	1/2"
SPIP DT 600	600Nm	1.5Nm	60mNm	3/4"

## RUN DOWN ADAPTERS

Designed to provide consistent and reliable torque readings for use with power driven torque control tools. Reduces the impact and irregular peaks that cause poor repeatability. Each RDA has an effective Torque Range and will supply repeatable torque data within that range if used correctly. It's mounted in-line between the tool drive and transducer. These run down Adapters are designed to provide consistent and reliable torque readings for use with power driven torque control tools.



Part No.	Accuracy	Resolution	Square
RDA 10i	0.1 - 1Nm	1/4"	63mm
RDA 25i	0.3 - 3Nm	1/4 "	63mm
RDA 50i	0.6 - 6Nm	1/4 "	63mm
RDA 100i	1 - 12Nm	/4 "	63mm
RDA 250i	2.8 - 28Nm	1/4 "	60mm
RDA 50F	6 - 60Nm	3/8"	83mm
RDA 100F	13 - 135Nm	1/2"	83mm
RDA 250F	30 - 300Nm	1/2"	83mm
RDA 500F	65 - 650Nm	3/4"	111mm
RDA 1000F	140 - 1400Nm	1"	182mm

## CENTOR FIRST – DIGITAL FORCE GAUGE

The force gauge Centor First is a simple and yet complete digital force gauge which uses efficient technology to simplify force measurements. A big display shows the force measured in tension or compression in the unit selected by the operator: newtons, kilograms or pounds. The bar graph completes the measurement. It can be used on a test stand (manual or motorized) or as a manual force gauge.

The three keys make it very easy to use this force gauge and access the essential functions: measurement of the peak tension or compression value, resetting to zero and changing the measuring units. It is an ideal tool for basic tests during production. Its metal casing, protected by an elastomer hull, gives it exceptional strength.

The internal sensor stands up to an overload of 200% of its maximum capacity. Simple, accurate, robust, supplied with its own carrying case, mains adaptor and certificate of calibration, ready for use, it is the basic force gauge for force measurement.

### Specifications:

- Accuracy: 0,25% FS
- Resolution: 1 / 1,000
- Sampling Rate: 1,000Hz
- Auto-off: 15min
- Bargraph: ✓
- Units: N, lb, kg, g, oz
- Battery Life: 8 hours



Part No.	Capacity	Model	RS232 Port
CNR-FT-100	100N	Centor First	No
CNR-FT-250	250N	Centor First	No
CNR-FT-500	500N	Centor First	No
CNR-FTXZ-100	100N	Centor First XZ	Yes
CNR-FTXZ-250	250N	Centor First XZ	Yes
CNR-FTXZ-500	500N	Centor First XZ	Yes

## CENTOR EASY – GRAPHICAL FORCE GAUGE

The Centor Easy force gauges are designed to meet the production needs of its users. This group offers several features which are indispensable today for quality control, for example ease of reading with its large backlight graphical display, RS232 output, memory of the last 100 values and ability to set thresholds with visual and sound alarms.

A new STATISTICS feature is available on the new Centor Easy models: the average and standard deviation of the current batch are calculated and displayed after each measurement. All the values of the production batch are kept in the memory and can be sent to a computer by RS232. The operator is spared any data entry, knows his results in real time and saves everything at the end of the tests.

The entirely configurable RS232 output sends the data to a PC

### Specifications:

- Accuracy: 0.1% FS
- Resolution: 1 / 10,000
- Sampling Rate: 1,000 Hz
- Auto-off: Adj 5 to 15min
- Overload Protection: 200%
- Calibration Cert incl.: ✓
- Bargraph: ✓
- Units: N, lb, kg, g, oz
- Tare Function: ✓
- Use of a Foot Pedal: ✓
- Battery Life: 8 hours



Part No.	Capacity	Model	RS232 Port
CNR-EA-10	10N	Centor Easy	Yes
CNR-EA-25	25N	Centor Easy	Yes
CNR-EA-50	50N	Centor Easy	Yes
CNR-EA-100	100N	Centor Easy	Yes
CNR-EA-250	250N	Centor Easy	Yes
CNR-EA-500	500N	Centor Easy	Yes
CNR-EA-1000	1000N	Centor Easy	Yes

## CENTOR STAR TOUCH – ADVANCED TOUCH SCREEN FORCE GAUGE

Centor Touch is designed for manufacturing environments, providing performance and easy operations to use and understand with the addition of the new, colored touch screen technology. Icons guide the operator in the selection of the appropriate measurement technique and method for their application. Setup menus, prompts and results are available in multiple languages.

### Specifications:

- Tension and Comp.: ✓
- Accuracy: 0.1% FS
- Resolution: 1 / 10,000
- Sampling Rate: 1,000Hz
- Auto-off: Adj – 5 to 15min
- Overload Protection: 200%
- Calib. Certificate incl.: ✓
- Bargraph: ✓
- Units: N, lb, kg, g, oz
- Tare Function: ✓
- Use of a Foot Pedal: ✓
- Internal Memory: ✓
- Statistics on 100 Tests: ✓
- Backlight Display: ✓
- Display Curve (force/time): ✓
- Automatic Calculations: ✓
- Memory Card Comp.: ✓
- Simultaneous Reading of two Channels: ✓
- Recognition of Displacement Sensors: ✓
- Battery Life: 8 hours



Part No.	Capacity	Model	RS232 Port
CNR-CT-5	5N	Centor Star Touch	Yes
CNR-CT-10	10N	Centor Star Touch	Yes
CNR-CT-25	25N	Centor Star Touch	Yes
CNR-CT-50	50N	Centor Star Touch	Yes
CNR-CT-100	100N	Centor Star Touch	Yes
CNR-CT-250	250N	Centor Star Touch	Yes
CNR-CT-500	500N	Centor Star Touch	Yes
CNR-CT-1000	1000N	Centor Star Touch	Yes

## CENTOR DUAL – 2 CHANNEL FORCE GAUGE

Thanks to its ability to read two sensors simultaneously with a 500 Hertz sampling rate per channel, the Centor Dual is a true test console designed for advanced force testing. It offers all of the functionality of an efficient force gauge and its calculating power enables it to save values from two different sensors simultaneously and perform calculations on each channel.

It also traces an F1/F2 graphs on its display or even a force / displacement graph, as well as read potentiometric rules and incremental encoders.

### Specifications:

- Tension / Comp.: ✓
- Accuracy: 0.1% FS
- Resolution: 1 / 10,000
- Sampling Rate: 1000 Hz
- Auto-off: Adj - 5 to 15 min
- Bargraph: ✓
- Units: N, lb, kg, g, oz
- Use of a Foot Pedal: ✓
- Internal Memory: ✓
- Statistics on 100 Tests: ✓
- Display Curve (force/time): ✓
- Automatic calc.: ✓
- Memory Card comp.: ✓



Part No.	Capacity	Model	RS232 Port
CNR-DL-5	5N	Centor Dual	Yes
CNR-DL-10	10N	Centor Dual	Yes
CNR-DL-25	25N	Centor Dual	Yes
CNR-DL-50	50N	Centor Dual	Yes
CNR-DL-100	100N	Centor Dual	Yes
CNR-DL-250	250N	Centor Dual	Yes
CNR-DL-500	500N	Centor Dual	Yes
CNR-DL-1000	1000N	Centor Dual	Yes

## STAHLWILLE AUTOMATIC CALIBRATION AND ADJUSTMENT DEVICE 7794-3

Controlled tightening of fasteners is becoming increasingly important and is a must for safety and quality assurance. As clear confirmation of its expertise in the field of controlled tightening, STAHLWILLE is accredited by the DAkkS accreditation authority (Deutsche Akkreditierungsstelle) as an approved calibration laboratory for «torque».

- Automatically calibrates electronic torque and angle-controlled wrenches made by STAHLWILLE
- From 1 to 400 N·m
- Design patent
- Other patents applied for
- Model is the same as perfectControl No 7794-2, except it is additionally suited to calibrating angle-controlled wrenches. Optimum adaptation to working height with motorised height adjustment
- Calibration up to 1000 N·m is possible using the easily attached expansion unit No 7791-1 and set of adapter plates No 7791-4, Code 52110491

### Contents:

- 6 calibrating square drive insert tools No 734K (sizes 4, 5, 12, 20, 40, 100)
- 6 square drive adaptors (No 409M, No 7787, No 7788, No 7789, No 7789-4, No 7789-5)
- 1 USB adaptor No 7757-1
- 1 software Torkmaster 7731-1
- 1 jack cable No 7751
- 1 spiral cable No 7752
- 1 spiral cable No 7751-2 with jack plug and self-locking precision plug
- 1 low-temperature cable connector
- 1 hexagon key wrench No 10760CV size 2 mm are included
- Supplied without torque wrench, transducer or notebook



Part No.	Capacity N·m	for Transducer	for torque wrenches with functional length (LF) max. mm	Profile width mm	Dimensions (W x H x L)	Weight (kg)
96521094	1-400	110/240V	815	180	640 x 884-1134 x 1060	230

## STAHLWILLE TRANSDUCERS

- For calibration of torque wrenches and torque screwdrivers
- High degree of accuracy thanks to conversion and digitization of readings within the transducer itself
- Not susceptible to lateral forces due to low-profile construction
- Can also be used as part of a calibration system (see p. 241, 245)
- With certificate
- Supplied in sturdy plastic box
- Measuring ranges by deviation of indication



<sup>1</sup> for calibrating torque screwdrivers

<sup>2</sup> for use with mechanical loader No 7792 and 7792-1

Part No.	Model	Display deviation value ± 1% of the reading			Display deviation value ± 0.5% of the reading			Display deviation value ± 0.25% of the reading			Dia (mm)	Drive Size (in)	Weight (g)
		N·m	ft·lb	in·lb	N·m	ft·lb	in·lb	N·m	ft·lb	in·lb			
96521021	7721 <sup>1</sup>	0,2-10	0,15-7,4	1,8-88,5	1-10	0,74-7,4	8,9-88,5	2-10	1,5-7,4	17,7-88,5	120	1/4	1735
96521000	7721-0	0,2-10	0,15-7,4	1,8-88,5	1-10	0,74-7,4	8,9-88,5	2-10	1,5-7,4	17,7-88,5	120	1/4	1735
96521026	7721-1	0,4-20	0,3-15	3,5-177	2-20	1,5-15	18-177	4-20	3-15	35-177	120	1/4	1735
96521022	7722	2-100	1,5-74	18-885	10-100	7-74	89-885	12-100	9-74	106-885	120	3/8	2486
96521023	7723-1	4-200	3-148	35-1770	20-200	15-148	177-1770	40-200	30-148	354-1770	120	1/2	2983
96522023	7723-2	8-400	6-295	71-3540	40-400	30-295	354-3540	80-400	59-295	708-3540	120	3/4	3134
96521028	7723-3	25-1100	18-812	221-9736	110-1100	81-812	974-9736	220-1100	162-812	1947-9736	120	3/4	2998
96521029	7724-1 <sup>2</sup>	150-3000	111-2214	1328-26553	300-3000	221-2214	2655-26553	600-3000	443-2214	5311-26553	195	1 1/2	10500

## STAHLWILLE ELECTRONIC TORQUE TESTER FOR TORQUE WRENCHES SENSOTORK® 7707 W

- compact torque tester for easy adaptation by replacement of the transducers
- high degree of accuracy thanks to flat transducer and conversion and digitalisation of readings within the transducer
- high degree of safety through display showing actual torque read-off where clicking torque wrenches are used
- for clockwise and anticlockwise use
- units of measurement: N·m, ft·lb, in·lb
- the easily interchangeable transducers are attached to the holder by means of a QuickRelease safety lock
- Interchangeable square drive adapters: A set of interchangeable square drive adapters are conveniently stored in the mounting block for a range of different drive sizes.
- low lateral forces thanks to low-profile transducers
- automatic detection of the transducer
- flexible and user friendly because the unit can be used horizontally or vertically and the display unit can be placed in many positions
- additional tripod with 1.5 m cable for mounting the display unit to facilitate visual monitoring when using longer torque wrenches
- especially broad measuring range from approx. 2 % to 100 % of rated value
- the software No 7759-4, including USB hub and jack cable, enables readings to be transferred to the PC for documenting (no separate power supply needed, power comes from PC)
- while individual transducers are being recalibrated, the torque tester itself remains on-site for further use
- wide range of application (-20°C to +60°C)
- complies with DIN 51309: 2005, Class 2 and DKD-R 3-8: 2003
- with certificate

### Contents:

- Electronic torque tester for torque wrenches, consisting of:
  - transducer (patent)
  - holder
  - display unit (registered design)
  - tripod for display unit (with 1.5 m cable)
  - spiral cable
  - mains adaptor (110 V–230 V with interchangeable socket adaptors) or direct connection to 12 V in-car supply is possible
  - square drive adaptor (No 7707-2W, No 7707-2-1W, No 7707-2-2W, No 7707-3W)
  - kit for attaching the unit to a workbench or wall in a horizontal or vertical testing position
  - supplied in sturdy plastic box



Part No.	Model	Capacity N·m	Capacity ft·lb	Capacity in·lb	Drive Size	Width (mm)	Base Height (mm)	Total Height (mm)	Depth (mm)	Weight (g)
96521086	7707-1-3W <sup>1</sup>	0.2-10	0.15-7.4	1.8-88.5	1/4	180	79	215	180	6255
96521085	7707-1-2W	0.2-10	0.15-7.4	1.8-88.5	1/4	180	79	215	180	6255
96521080	7707-1W	0.4-20	0.3-15	3.5-177	1/4	180	79	215	180	6255
96521072	7707-2W <sup>2</sup>	2-100	1.5-74	18-885	3/8	180	79	215	180	7025
96521083	7707-2-1W <sup>3</sup>	4-200	3-148	35-1770	1/2	180	79	215	180	7511
96521084	7707-2-2W <sup>4</sup>	8-400	6-295	71-3540	3/4	180	79	215	180	7654
96521082	7707-3W <sup>4</sup>	25-1100	18-812	221-9736	3/4	180	79	215	180	7495

## STAHLWILLE TESTER FOR TORQUE WRENCHES AND TORQUE SCREWDRIVERS SMARTCHECK

- compact construction
- for horizontal or vertical mounting
- display, display mount and base body can be rotated through 180°
- three operating modes (track, first peak, peak hold)
- three measuring units (N·m, ft·lb, in·lb)
- the target torque and tolerances can be set individually to evaluate the readings
- operating mode using a mains adaptor or battery (4 x AAA or 1 x 9 V block, adaptor included)
- with integrated visual and audible overload protection mechanism
- the display and keypad are splash-proof, and the housing is made of impact-resistant plastic
- with certificate
- supplied in sturdy plastic box
- display deviation value ± 1%



Part No.	Model	Capacity N·m	Capacity ft·lb	Capacity in·lb	Drive Size	Width (mm)	Height (mm)	Depth (mm)	Weight (g)
96521201	SmartCheck 10S *	1-10	0.74-7.4	8.9-88.5	1/4	120	124	167	5210
96521202	SmartCheck 10	1-10	0.74-7.4	8.9-88.5	1/4	120	124	167	5210
96521203	SmartCheck 100	10-100	7-74	89-885	3/8	120	124	167	5310
96521204	SmartCheck 400	40-400	30-295	354-3540	3/4	120	124	167	5690
96521205	SmartCheck 800	80-800	59-590	708-7081	3/4	120	124	167	5690

<sup>1</sup> for calibrating torque screwdrivers

<sup>2</sup> with square drive adaptor No 409M (1/4" a x 3/8" D)

<sup>3</sup> with square drive adaptors No 7789-4 (1/4" a x 1/2" D). No 7789-5 (3/8" a x 1/2" D)

<sup>4</sup> with square drive adaptors No 7787 (1/4" a x 3/4" D). No 7788 (3/8" a x 3/4" D). No 7789 (1/2" a x 3/4" D)

## DESOUTTER DELTA TORQUE ANALYZERS

DELTA 1D



Torque measurement ideal for torque wrench or pulse tool test together with DRT or DST transducers. Delta 1D doesn't require any programming, it's ready to test the selected tool showing in real time Mins, Max and Average. Complete results and XLS reports are available to be exported from Delta QC Free version software.

DELTA 6D



DELTA 6D reads Angle from DRT transducer, ideal to test advanced electric nutrunner T&A strategies. DELTA 6D introduces Tool and PSet and definition with Route management, Statistic (ISO, CNOMO or NF standards), Curve and serial communication to CVI controller or Barcode. SPC analysis, curve overlay and off-line programming are available in combination with Delta QC Licensed version

DELTA 7D



DELTA 7D combines all DELTA 6D features with DWTA wrench communication for Residual Torque check available with Torque plus Angle strategy. Thanks to the new joint analysis strategy the Delta 7D in combination with DWTA becomes the perfect measurement instrument to characterise the real joint in the line, a key feature to:

- find real joint yield point
- set the production tightening tool with the correct torque and angle values increasing the quality in the overall production process.

	DELTA 1D	DELTA 6D	DELTA 7D
<b>TRANSUCER</b>			
Connection to DRT4, DRT5, DST	•	•	•
Connection to DWT, DWTA			•
Angle Measurement		•	•
<b>ON BOARD FUNCTIONALITY</b>			
Wrench Test	•	•	•
Nutrunner Test	•	•	•
Pulse Tool Test	•	•	•
Tools	1	1000	1000
Pset		1000	1000
Integrated Statistic	Min, Max Avg	Cm, Cmk (ISO, NF and CNOMO standards)	Cm, Cmk (ISO, NF and CNOMO standards) + SPC
Quality Strategy			•
Results	1000	5000	5000
Curve		10	10
CVI Autocalibration		•	•
External Barcode connectivity		•	•

Part No.	Model No	Battery hours	Charger Volts	Depth mm	Depth in.	Width mm	Width in.	Height mm	Height in.	Weight kg	Weight lb
615 935 101 0	Delta 1D	16	110/240 V	45	1,77	95	3,74	192	7,56	0,5	1,10
615 935 102 0	Delta 6D	16	110/240 V	45	1,77	95	3,74	192	7,56	0,5	1,10
615 935 103 0	Delta 7D	16	110/240 V	45	1,77	95	3,74	192	7,56	0,5	1,10

Part No.	Description
615 936 141 0	Rubber Protection
615 917 671 0	CMD & ST 4000 Adapter
615 917 672 0	CMD 5000 Adapter
615 917 670 0	RS232 Adapter

Part No.	Description
615 917 674 0	GSE 2500 Adapter
615 917 675 0	GSE 8500T Adapter
615 917 676 0	GSE 8500T/A Adapter
615 936 140 0	Delta Demo Case (Empty)

Part No.	Description
615 927 651 0	Delta QC Licensed 1 User
615 927 652 0	Delta QC Licensed 5 Users
615 927 653 0	Delta QC Advanced 1 User
615 927 654 0	Delta QC Advanced 5 Users

## DESOUTTER ALPHA LOW TORQUE ANALYZER

Dedicated torque analyzers for the setting and static test checks of low torque screwdrivers, either pneumatic or electric.

Specifications:

- Torque Transducer Embedded
- Torque Accuracy +/-1% of readings
- Tools Testing Torque Wrench, Nutrunner or Pulse Tools
- Statistic Min, Max, Average, Standard Deviation
- Results Storage 1000 + 10 curves with DeltaQC Licenced
- Multi-units N.m, Kg.m, Kg.cm, Oz.in, Lb.in, Lb.ft, N.cm
- Display Red, Green, Blue backlight
- Power Supply Embedded Battery External power supply
- Battery Autonomy Up to 12 hours
- Languages French, English, Spanish, Italian, Deutsch, Portuguese
- Software Free Delta QC Software to export by USB result



Backlight RGB color display with acoustic buzzer



Features:

- Alpha D Series is designed to monitor and collect torque check results from screwdrivers, torque wrenches or click wrenches.
- Ideal to tune the tools thanks to real time statistics on color display and high capacity torque results storage.
- Traceability with included software result acquisition with time stamp, including PDF or XLS reports.
- Three models with embedded transducer to cover torque range from 0,1 to 16 Nm. All models are provided with two included joint simulators to test nutrunner according to different joint stiffness condition.
- All models are supplied with external power supply, suitable hard and soft joint simulators and Delta QC Software

Part No.	Model	P. Charger V	Torque Range		Dimensions (mm)			Weight				
			Nm	in.lb	Depth mm	Width in	Height mm	kg	lb			
615 935 140 0	Alpha D1	110/240V	0.1 - 1	0.88 - 8.85	106	4.17	180	7.09	70	2.76	0.95	2.1
615 935 141 0	Alpha D5	110/240V	0.5 - 5	4.42 - 44.25	106	4.17	180	7.09	70	2.76	0.95	2.1
615 935 142 0	Alpha D16	110/240V	1.6 - 16	14.1 - 141.6	106	4.17	180	7.09	70	2.76	0.95	2.1

## DESOUTTER DIGITAL ROTARY TRANSUCERS & ACCESSORIES – TORQUE AND ANGLE

The DRT5 series associated with a Delta 6D or Delta 7D are including an Angle measurement encoder to allow both Torque AND Angle quality controls (preferred series in case you are using Angle strategies and/or monitoring).

Features:

- Built-in smart chip memory with calibration features: - type of transducer - sensitivity nominal load - serial number.
- Torque range from 0.2 to 5000 Nm (0.15 to 3685 ft.lb).
- Angle counting system 0.35° resolution.
- Strain gauges transducer: - sensitivity 2mV/V - accuracy +/-0.35% of max. torque.

Benefits:

- Automatic recognition thanks to internal memory chip storing main data values eliminating any setting mistakes and time losses.
- High reliability due to immunity from external noise thanks to digital communication.
- Communication to data analyzer not sensitive to the cable length.
- Long life durability thanks to industrial design from transducer to housing.

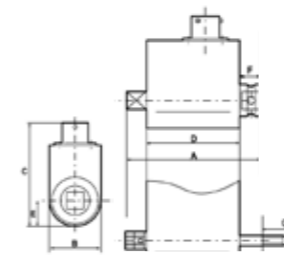

Output	A		B		C		E		H		F		G	
	mm	in	mm	in	mm	in	mm	in	mm	in	mm	in	mm	in
Hex 1/4"	116	4.56	31	1.22	71.9	2.83	56	2.2	15.5	0.61	39	1.53	25.5	1
Sq 1/4"	71.5	2.81	31	1.22	71.9	2.83	56	2.2	15.5	0.61	6	0.24		
Sq 3/8"	77	3.03	31	1.22	71.9	2.83	56	2.2	15.5	0.61	8	0.31		
Sq 1/2"	87	3.42	42	1.65	82.9	3.26	58	2.28	21	0.83	12	0.47		
Sq 3/4"	106	4.17	52	2.05	92.9	3.66	66	2.60	26	1.02	21	0.83		
Sq 1"	125	4.92	65	2.56	104.9	4.13	73	2.87	32.5	1.28	29	1.14		
Sq 1-1/2"	165	6.5	106	4.17	148.5	5.85	88	3.46	53	2.09	35.2	1.39		

Part No.	Model	Torque Range		Output lb
		Nm	ft.lb	
615 165 218 0	DRT 5 H 2	0.2 - 2	0.15 - 1.5	Hex 1/4"
615 165 219 0	DRT 5 H 5	0.5 - 5	0.37 - 3.7	Hex 1/4"
615 165 220 0	DRT 5 H 20	2 - 20	1.47 - 14.7	Hex 1/4"
615 165 221 0	DRT 5 Sq 20	2 - 20	1.47 - 14.7	Sq 1/4"
615 165 222 0	DRT 5 Sq 25	2.5 - 25	1.84 - 18.4	Sq 3/8"
615 165 223 0	DRT 5 Sq 75	7.5 - 75	5.53 - 55.3	Sq 3/8"
615 165 224 0	DRT 5 Sq 180	18 - 180	13.2 - 132	Sq 1/2"
615 165 225 0	DRT 5 Sq 500	50 - 500	36.8 - 368	Sq 3/4"
615 165 226 0	DRT 5 Sq 1400	140 - 1400	103.2 - 1032	Sq 1"
615 165 780 0	DRT 5 Sq 5000	500 - 5000	368.5 - 3685	Sq 1-1/2"

Note: The DRT shall not be used with pulse tools over 50 % of the transducer nominal torque.

## DESOUTTER DIGITAL ROTARY TRANSDUCERS – TORQUE

The DRT4 rotary transducer series are designed to measure torque output (Only) of any non-impact assembly tool, directly on your application in dynamic mode.

### Features:

- Torque range from 0,2 to 10000 Nm (0.15 to 7375 ft.lb).
- Strain gauges transducer: - sensitivity 2mV/V - accuracy +/-0.35% of max. torque.
- Built-in smart chip memory with calibration features: - type of transducer - sensitivity nominal load - serial number.

Note: The DRT shall not be used with pulse tools over 50 % of the transducer nominal torque



Part No.	Model	Torque Range		Output
		Nm	ft.lb	
615 165 209 0	DRT 4 H 2	0.2 - 2	0.15 - 1.5	Hex 1/4"
615 165 210 0	DRT 4 H 5	0.5 - 5	0.37 - 3.7	Hex 1/4"
615 165 211 0	DRT 4 H 20	2 - 20	1.47 - 14.7	Hex 1/4"
615 165 212 0	DRT 4 Sq 20	2 - 20	1.47 - 14.7	Sq 1/4"
615 165 213 0	DRT 4 Sq 25	2.5 - 25	1.84 - 18.4	Sq 3/8"
615 165 214 0	DRT 4 Sq 75	7.5 - 75	5.53 - 55.3	Sq 3/8"
615 165 215 0	DRT 4 Sq 180	18 - 180	13.2 - 132	Sq 1/2"
615 165 216 0	DRT 4 Sq 500	50 - 500	36.8 - 368	Sq 3/4"
615 165 217 0	DRT 4 Sq 1400	140 - 1400	103.2 - 1032	Sq 1"
615 165 536 0	DRT 4 Sq 3000	300 - 3000	221.1 - 2211	Sq 1-1/2"
615 165 540 0	DRT 4 Sq 1400	500 - 5000	368.5 - 3685	Sq 1-1/2"
615 935 164 0	DRT4 Sq 10000	1000 - 10000	736.6 - 7375	Sq 1-1/2"

## DESOUTTER PST PULSE STATIC TRANSDUCER

Designed for testing hand wrenches, click wrenches, Pneumatic Pulse tools and electric nutrunners, the Pulse Static Transducer is the ideal solution to provide a periodic and static mean of control for audit at the station and will cover all your assembly tools in the production area.

### Features:

- Torque accuracy +/-0.35% of torque max.
- Built-in smart chip memory with calibration features: - type of transducer - sensitivity nominal load - serial number
- Lever to clamp the Joint simulator firmly for impulse tools
- Recommended for Pulse tools

(Reminder: the joint simulator is required accessory in the case of a shut-off pulse or nutrunner tool test).



Part No.	Model	Torque Range		Dimensions (mm)								Input	Weight	
		Nm	in.lb	A	B	C	D	E	F	G	H		kg	lb
615 935 220 0	PST 2 Nm - 13	0.2 - 2	0.15-1.5	83	39	80	69	45	64	4x Ø 6.5	/	Sq 1/2"	1.4	3.1
615 935 221 0	PST 5 Nm - 13	0.5 - 5	0.37 - 3.7	83	39	80	69	45	64	4x Ø 6.5	/	Sq 1/2"	1.4	3.1
615 935 222 0	PST 10 Nm - 13	1-10	0.74-7.4	83	39	80	69	45	64	4x Ø 6.5	/	Sq 1/2"	1.4	3.1
615 935 223 0	PST 25 Nm - 36	2.5-25	1.8-18	134	50	106	96	70	89	4x Ø 8.5	123	Hex 36"	4	8.8
615 935 224 0	PST 50 Nm - 36	5-50	3.7-37	134	50	106	96	70	89	4x Ø 8.5	123	Hex 36"	4	8.8
615 935 225 0	PST 100 Nm - 36	10-100	7.4-74	134	50	106	96	70	89	4x Ø 8.5	123	Hex 36"	4	8.8
615 935 226 0	PST 250 Nm - 36	25-250	18.4-184	134	50	106	96	70	89	4x Ø 8.5	123	Hex 36"	4	8.8
615 935 227 0	PST 500 Nm - 50	50 - 500	36.9-369	170	50	148	136	108	125	6x Ø 8.5	180	Hex 50"	10.1	22.3
615 935 228 0	PST 1000 Nm - 50	100-1000	73.8-738	170	50	148	136	108	125	6x Ø 8.5	180	Hex 50"	10.1	22.3
615 935 229 0	PST 2000 Nm - 50	200-2000	147.5-1475	170	50	148	136	108	125	6x Ø 8.5	180	Hex 50"	10.1	22.3

## DESOUTTER JOINT SIMULATOR

A wide range of mechanical joint simulators are available to reproduce the joint behavior; installing the joint simulator on a transducer allows you to test a tool in the same repeatable working conditions. Each joint simulator reproduces a specific stiffness as described in its torque/angle characteristics. For each capacity, there are two versions: one reproducing a softer joint and one reproducing a harder joint.



Part No.	Model	Color	Dimensions (mm)						
			A	B	C	D	E	F	G
615 165 529 0	DJS for DST and PST 2 Nm SOFT	YW - YW	HEX 1/4"	14	24	Sq. 1/2"	8	50	71,5
615 165 530 0	DJS for DST and PST 2 Nm HARD	YW - BK	HEX 1/4"	14	24	Sq. 1/2"	8	50	71,5
615 165 531 0	DJS for DST and PST 5 Nm SOFT	GR - YW	HEX 1/4"	14	24	Sq. 1/2"	8	50	71,5
615 165 571 0	DJS for DST and PST 5 Nm HARD	GR - BK	HEX 1/4"	14	24	Sq. 1/2"	8	50	71,5
615 936 377 0	DJS for PST 10 Nm SOFT	RD - YW	HEX 1/4"	14	24	Sq. 1/2"	8	50	71,5
615 936 378 0	DJS for PST 10 Nm HARD	RD - BK	HEX 1/4"	14	24	Sq. 1/2"	8	50	71,5
615 936 379 0	DJS for PST 25 Nm SOFT	RD - YW	Sq. 3/8"	11	34	Hex 36"	16,5	70	120,5
615 936 380 0	DJS for PST 25 Nm HARD	RD - BK	Sq. 3/8"	11	34	Hex 36"	16,5	70	120,5
615 936 381 0	DJS for PST 50 Nm SOFT	BL - YW	Sq. 1/2"	15	41	Hex 36"	18	84	133,5
615 936 382 0	DJS for PST 50 Nm HARD	BL - BK	Sq. 1/2"	15	41	Hex 36"	18	84	133,5
615 936 365 0	DJS for PST 100 Nm SOFT	VL - YW	Sq. 1/2"	15	41	Hex 36"	18	84	133,5
615 936 366 0	DJS for PST 100 Nm HARD	VL - BK	Sq. 1/2"	15	41	Hex 36"	18	84	133,5
615 936 384 0	DJS for PST 250 Nm SOFT	GY - YW	Sq. 1/2"	15	41	Hex 36"	18	84	133,5
615 936 385 0	DJS for PST 250 Nm HARD	GY - BK	Sq. 1/2"	15	41	Hex 36"	18	84	133,5
615 936 369 0	DJS for PST 500 Nm SOFT	BK - YW	Sq. 3/4"	22	59	Hex 50"	30	141	224
615 936 370 0	DJS for PST 500 Nm HARD	BK - BK	Sq. 3/4"	22	59	Hex 50"	30	141	224
615 936 386 0	DJS for PST 1000 Nm	no color	Sq. 1"	28	90	Hex 50"	30	179	273
615 936 393 0	DJS for PST 2000 Nm	no color	Sq. 1"	28	90	Hex 50"	30	179	273

## DESOUTTER JOINT SIMULATOR KITS

Soft / Hard joints – Min / Max Torques

### Contents:

1. DJSxs assembly - min. torque - Soft joint x1
2. Spare compression spacer - min. torque - Soft x4
3. Spare compression spacer - min. torque - Hard x1
4. DJSxs assembly - min. torque - Hard joint x1
5. DJSxs assembly - nominal torque - Hard joint x1
6. Spare compression spacer - nominal torque - Hard joint x1
7. Spare compression spacer - nominal torque - Soft joint x4
8. DJSxs assembly - nominal torque - Soft joint x1
9. DJSxs20 assembly - min./nominal torque - Soft joint - spacer for DSTxs adapter
10. DJSxs20 assembly - min./nominal torque - Hard - spacer for DSTxs adapter

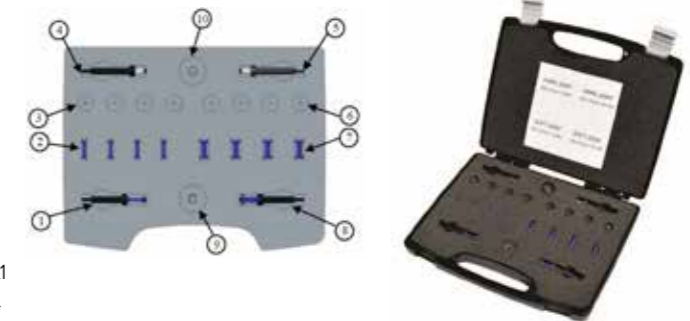

Part No.	Model	Joints covered				Adapter	Screw Size
		Hard / mini	Soft / mini	Hard / max	Soft / max		
615 936 445 0	DJSxs 20	2-6 cNm	2-6 cNm	20 cNm	20 cNm	dia 3mm	M2
615 936 446 0	DJSxs 50	5-15 cNm	5-15 cNm	50 cNm	50 cNm	Hex 1/4	M2 & M3
615 936 447 0	DJSxs 80	8-24 cNm	8-24 cNm	80 cNm	80 cNm	Hex 1/4	M3

## DESOUTTER ADAPTER

Direct adapter for Non shut-off pulse tools and click wrenches (without DJS).



Part No.	Model
615 936 399 0	HEX 36 M-1/2" F
615 936 431 0	HEX 50 M-1/2" F
615 936 432 0	HEX 50 M-3/4" F
615 936 433 0	HEX 50 M-1" F
615 936 118 0	HEX 1/4" M-1/4" F
615 936 119 0	HEX 1/4" M-3/8" F

## DESOUTTER TRANSDUCER CABLES



Part No.	Model	Description
615 917 430 0	2m (78.7") - 10 pins	For DRT / PST / DSTxs / FCT - all Delta Models
615 917 432 0	2m (78.7") spiral - 10 pins	For DRT / PST / DSTxs / FCT - all Delta Models
615 917 433 0	5m (196.8") - 10 pins	For DRT / PST / DSTxs / FCT - all Delta Models



## DESOUTTER CLAMP FORCE TRANSDUCERS – FCT

Measure Pulse Tools repeatability in tension

The purpose of the FCT is to measure the repeatability of a pulse tool in achieving a constant tension independently from the friction effects and detect a deviation over time. Delta 6D/7D can display both the load and equivalent torque.

Features:

- Accuracy +/-0,5% of Applied Force Reading Value.
- Built-in Load Cell.
- Used with Delta xD data collectors and cables.
- Battery powered with up to 12 hours autonomy.
- Allows a display of both Clamping Force and Torque (K factor)
- Up to 2000 Hz filter selection
- RS-232 interface to download readings in "real time"
- Large screen and easy to use menus (5 languages)
- Supplied with screw kit and 3/8" socket SW13

Benefits:

- Measures the repeatability of pulse tools to achieve a target clamping force.
- By measuring the clamp force instead of the torque delivered, the adverse effects of adding an in-line torque transducer are eliminated.
- As most design offices specify a clamping force, measuring the actual clamping force allows to eliminate the uncertainty linked to the translation in torque of a clamping value.

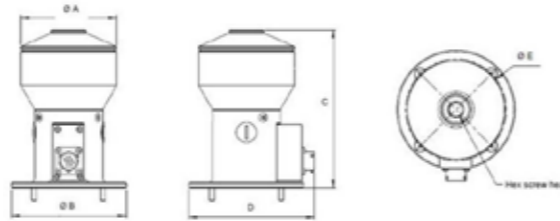

Ø A		Ø B		C		D		Ø E	
mm	in	mm	in	mm	in	mm	in	mm	in
96	3.779	115	4.779	157.8	6.21	125.8	4.952	98	3.858

Part No.	Model	Torque Range		Load Range		Overload Force		Overload Torque		Weight	
		cNm	ft.lbs	N	lbf	mm	in	mm	in	kg	lb
615 935 249 0	FCT30	10-30	7.38-22.13	1800-18000	405-4050	23400	5260	39	28.7	2.4	5.3
615 935 250 0	FCT60	20-60	14.75-44.25	2700-27000	607-6070	35100	7890	78	57.5	2.4	5.3

## DESOUTTER DIGITAL STATIC TRANSDUCERS – DSTXS

Nano-torques applications (< 1 Nm)

Features:

- Accuracy from 10% to 100% of the nominal torque : +/-0,5% FSD (Full Scale Deviation) - Overload at 120% of nominal capacity.
- Stability of Zero offset with temperature: < ±0.1% FSD/°C - Operating temperature: 5 to 40°C.
- Built-in memory with calibration features: Serial Number, Transducer Type, Sensitivity, Nominal Load, Calibration / Maintenance date, Tightening counter, Damage limit.

Benefits:

- Automatic recognition thanks to internal memory chip storing main data values eliminating any setting mistakes and time losses.
- High reliability due to immunity from external noise thanks to digital communication.
- Communication to data analyzer not sensitive to the cable length.

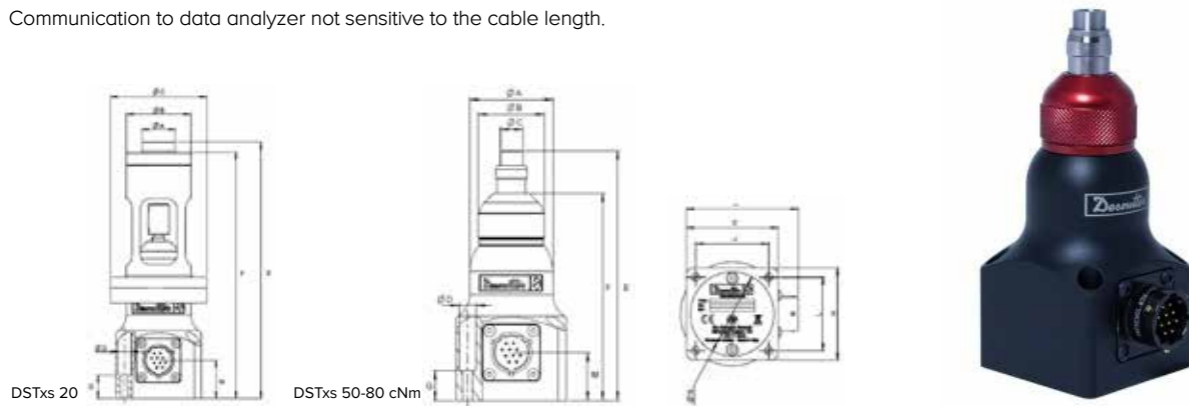

Part No.	Model	Torque Range		Square Drive	Dimensions (mm)								Weight			
		cNm	in.lbs		Ø A	Ø B	Ø C	L	H	kg	lb					
615 165 752 0	DSTxs 20 cNm	2-20	0.17-1.77	dia 3mm	20	0.787	39	1.535	58	2.283	41	1.614	51.5	2.027	0.56	1.2
615 165 754 0	DSTxs 50 cNm	5-50	0.44-4.42	Hex 1/4	39	1.535	32	1.259	10.5	0.413	41	1.614	51.5	2.027	0.42	0.9
615 165 764 0	DSTxs 80 cNm	8-80	0.70-7.08	Hex 1/4	39	1.535	32	1.259	10.5	0.413	41	1.614	51.5	2.027	0.42	0.9

## DESOUTTER COUPLINGS

Accessories for Static transducers & Joint simulators



Part No.	Model
615 397 205 0	3/4" M-1/4" F
615 397 206 0	3/4" M-3/8" F
615 397 207 0	1" M-1/2" F
615 397 208 0	1 1/4 M-1/2" F
615 397 209 0	1" 1/4 M-3/4" F
615 397 210 0	1/4" F-1/4" F
615 397 211 0	3/8" F-3/8" F
615 936 110 0	1" M-3/4" F

Part No.	Model
615 936 111 0	1/2" M -3/8" F
615 936 112 0	1/2" F-3/8" F
615 936 113 0	1/2" M-1/2" F
615 936 114 0	1 1/4 M-3/4" F
615 936 115 0	1/4" F-3/8" F
615 936 116 0	1" 1/4 M-1" F
615 936 117 0	1" F-1" F

Part No.	Model
615 936 118 0	HEX 1/4" M-1/4" F
615 936 119 0	HEX 1/4" M-3/8" F
615 936 126 0	1" F-3/4" F
615 936 130 0	3/4" F-1/2" F
615 936 131 0	1" 1/2 F-1" 1/2 F
615 165 573 0	1/2" F-1/2" F
615 165 576 0	3/4" F-3/4" F

## DESOUTTER CALIBRATION BENCH

Embedded transducers:

Assembly tools calibration process requires a flexible and versatile solution, high quality performance even in production lines. Desoutter Tools is proud to present the Delta Cart, an ergonomic and attractive solution to improve quality in assembly processes.

- Delta Cart offers a wide torque range since it can be configured up to 4 static transducers to cover from 0.2 Nm to 1 000 Nm (0.15 to 738 ft.lb) in a very compact dimensions (510mm width), making the Delta Cart the ideal solution for tool testing in assembly production lines.
- PST High accuracy static transducers with locking system specially designed for pulse tool calibration
- ISO RIG (mandatory over 200Nm) System for torque wrench calibration
- Embedded PC equipped with wide 12" color touch screen lets operators to start tool testing in a few seconds and few steps.
- Delta Cart includes all adapters, reaction bars and suitable joint simulators. Optional ISO RIG for torque wrench to eliminate operator influence during calibration, reducing efforts for high torque range.



## DESOUTTER CART TOOL CALIBRATION

Embedded transducers:

Assembly tools calibration process requires a flexible and versatile solution, high quality performance even in production lines. Desoutter Tools is proud to present the Delta Cart, an ergonomic and attractive solution to improve quality in assembly processes.

The Delta Cart is able to follow your tools during the complete life span: by performing capacity test (Cm/Cmk) before tool is introduced into production, or monitoring tool performance during production assembly process by performing Statistic Process Control (SPC) test

Features:

- Configurable torque range from 1 Nm to 2000Nm
- Torque reaction bar and joint simulator included
- External DRT communication for in-line calibration
- Angle Strategy with external DRT5
- CVI2 and CVI3 autocalibration
- Double reading calibration with automatic deviation check

For more information on custom-built calibration benches please contact us.



Electric and Pneumatic Nutrunner



Shut off and non shut off Pulse Tool



Torque wrench



Click wrench

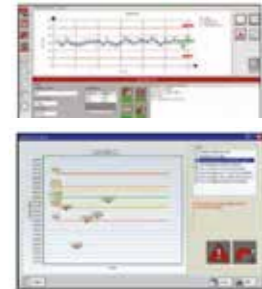

# Tensiometers

The familiar T5 Tensiometer is a low cost, highly accurate, precision instrument giving cable tension readings covering a wide range. In use, each T5 instrument is calibrated at the factory and is provided with its own calibration chart for the simple conversion of readings into pounds- tension. The charts shown, indicate the riser which must be used to accommodate the various cable sizes and tensions.

The T5 is a small, lightweight, precision instrument, durably constructed for long accurate service.

## T5-2000 SERIES TENSIO METER

This durable instrument may be used continuously without resetting or checking. Extreme heat or cold does not affect the accuracy of indicator readings. One instrument is usable on many cable sizes with absolute accuracy. The small size of this instrument permits entry through small openings, and permit accurate readings on cables located in confined areas difficult to reach.



Part No.	Range	Cable Selection	Riser
T5-2000-101-00	10 - 100lbs 15 - 150lbs 25 - 150 lbs	1/16, 3/32, 1/8 5/32, 3/16 7/32, 1/4	No. 1 No. 2C No. 3
T5-2002-103-00	30 - 160lbs 30 - 200lbs 30 - 150lbs	1/16, 3/32, 1/8 5/32, 3/16 7/32, 1/4	No. 1 No. 2C No. 3
T5-2002-104-00	30 - 200lbs 30 - 300lbs 30 - 300lbs	1/16, 3/32, 1/8 5/32, 3/16 7/32, 1/4	No. 1 No. 2C No. 3
T5-2002-104A-00	30 - 300lbs 30 - 300lbs 30 - 300lbs	1/16, 3/32 5/32, 3/16, 1/8 7/32, 1/4	No. 1 No. 2C No. 3
T5-2002-105-00	30 - 200lbs 30 - 400lbs 30 - 400lbs	1/16, 3/32, 1/8 5/32, 3/16 7/32, 1/4	No. 1 No. 2C No. 3
T5-2002-301-00	10 - 100lbs 15 - 150lbs 25 - 150lbs	3, 5, 10 (CWT) 15, 25 (CWT) 35, 45 (CWT)	No. 1 No. 2C No. 3

## T5-8000 SERIES TENSIO METER

This durable instrument may be used continuously without resetting or checking. Extreme heat or cold does not affect the accuracy of indicator readings. One instrument is usable on many cable sizes with absolute accuracy. The small size of this instrument permits entry through small openings, and permit accurate readings on cables located in confined areas difficult to reach.



Part No.	Range	Cable Selection	Riser
T5-8002-104B-00	10 - 100lbs 15 - 150lbs 25 - 150 lbs	1/16, 3/32, 1/8 5/32, 3/16 7/32, 1/4	No. 1 No. 2C No. 3
T5-8002-105-00	30 - 200lbs 30 - 400lbs 30 - 400lbs	1/16, 3/32, 1/8 5/32, 3/16 7/32, 1/4	No. 1 No. 2C No. 3A
T5-8002-211-00	35 - 350lbs	1/16, 3/32, 1/8	No. 2
T5-8002-401-00	10 - 100lbs 15 - 150lbs 25 - 150lbs 10 - 100lbs 15 - 150lbs 15 - 150lbs 25 - 150lbs	1/16, 3/32, 1/8 5/32, 3/16 7/32, 1/4 10, 15 (CWT) 15 (CWT) 20, 25 (CWT) 70 (CWT)	No. 1 No. 2C No. 3 No. 1 No. 2C No. 2C No. 3
T5-8003-106-00	40 - 600lbs 40 - 600lbs	3/16, 7/32, 1/4 5/16	No. 2C No. 3A
T5-8003-107-00	100 - 800lbs 100 - 800lbs	3/16, 7/32, 1/4 5/16	No. 2C No. 3A
T5-8003-108-00	200 - 1000lbs 200 - 1000lbs	3/16, 7/32, 1/4 5/16	No. 2C No. 3A

## DIGITAL CABLE TENSIO METER

- Digital cable tensiometer with backlight
- Select lbs, kg or newtons
- Accuracy is  $\pm 2\%$  full scale for all menu selectable calibrations
- Up to 10 calibrations can be programmed into the instrument, password protected
- Rechargeable NIMH batteries provide 6 hours of operation

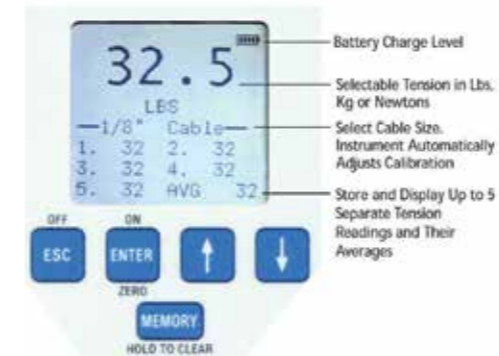

Part No.	Range	Resolution	Cable Selection
ACX-250	20-250lbs	0.5lb	1/16, 3/32, 1/8, 5/32
ACX-500	40-500lbs	1lb	3/32, 1/8, 5/32

## SAFETY WIRE DRILL JIG – AERO SAFTBLOK

- Precise cross drilling of bolts for safety wire
- Bolt Sizes 8-32, 10-32, 1/4-20 & 5/16-24



Part No.	Description
HM-MTE-1	Safety Wire Drill Jig – cross thread

## SAFETY WIRE DRILL JIG – NUT SAFTBLOK

- For clamping hexagonal bolt heads or nuts for cross drilling
- Accepts up to 3/4" diameter nuts or bolt heads
- Recommend use of 1/16" or 5/64" cobalt drill



Part No.	Description
HM-MTE-2	Safety Wire Drill Jig – cross hex

## MECHANICAL CABLE TENSIO METER

- Easy one-handed operation
- "Memory Lock" pointer holds reading till cleared
- Compact design allows use in confined areas
- Supplied in heavy duty padded bag



Part No.	Range	Cable Selection
HM-ACM-100	5-100lbs	1/16, 3/32, 1/8, 5/32
HM-ACM-200	20-200lbs	1/16, 3/32, 1/8, 5/32, 3/16
HM-ACM-300	40-300lbs	3/32, 1/8, 3/16, 1/4
HM-ACM-400	40-400lbs	3/32, 1/8, 5/32, 3/16
HM-ACM-600	40-600lbs	1/8, 5/32, 3/16, 1/4

## SWAGING TOOL

- Swaging Tool for oval copper sleeves
- Various tools available to suit other cable Sizes, please enquire



Part No.	Description	OAL
51B4887	Swaging Tool for 3/64" cable	475mm

## SWAGING TOOL

Swages 1/16", 3/32" and 1/8" oval sleeves



Part No.	Description
SF-002	Swaging Tool

## CABLE CUTTER

- Cuts up to 3/16" Diameter cable
- Produces a clean square cut

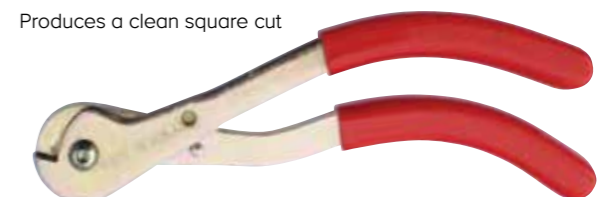

Part No.	Description	OAL
SF316	Cable Cutter	200mm